

**BUFFALO COUNTY BOARD OF COMMISSIONERS
TUESDAY, JANUARY 25, 2022**

The Buffalo County Board of Commissioners met on Tuesday, January 25, 2022 at 9:00 A.M. Chairman Klein called the meeting to order and led those present in the Pledge of Allegiance. The following Board members responded to roll call: Timothy Higgins, Myron Kouba, Ronald Loeffelholz, Daniel Lynch, Bill Maendele, Sherry Morrow and Ivan Klein. A copy of the acknowledgment and receipt of notice and agenda by the Board of Commissioners is attached to these minutes. Public notice of this meeting was published/posted in the Kearney Hub, on the Buffalo County web site, and the bulletin boards located outside the County Clerk's office and County Board Room on January 20, 2022. In accordance with Section 84-1412 of the Nebraska Revised Statutes, a current copy of the Open Meetings Act is available for review and posted at the back of the Board Room. County Clerk Janice Giffin took all proceedings hereinafter shown; while the convened meeting was open to the public. County Attorney Shawn Eatherton, Deputy County Attorney Andrew Hoffmeister and Deputy County Attorney Kari Fisk were present.

REGULAR AGENDA

Moved by Higgins and seconded by Maendele to approve the January 11, 2022 Board meeting minutes. Upon roll call vote, the following Board members voted "Aye": Higgins, Maendele, Kouba, Loeffelholz, Lynch, Morrow and Klein. Motion declared carried.

Moved by Morrow and seconded by Loeffelholz to ratify the following January 14, 2022 payroll claims processed by the County Clerk. Upon roll call vote, the following Board members voted "Aye": Morrow, Loeffelholz, Higgins, Kouba, Lynch, Maendele and Klein. Motion declared carried.

<u>GENERAL FUND</u>			
NET PAYROLL			285,219.81
AMERICAN FAMILY LIFE	I	PREMIUMS	1,201.59
RETIREMENT PLANS AMERITAS	R	EMPE RET	48,767.86
BUFFALO CO TREASURER	I	PREMIUMS	122,359.50
CREDIT MANAGEMENT	E	GARNISHMENT	169.94
EMPOWER RETIREMENT	R	DEFERRED COMP	1,125.00
FIRST CONCORD	E	FLEX FUNDS	5,267.10
FIRST NATIONAL BANK	T	FEDERAL TAXES	97,546.53
KEARNEY UNITED WAY	E	DONATIONS	114.67
MADISON NATIONAL	I	PREMIUMS	998.70
MADISON NATIONAL	I	LT DISABILITY	293.61
ERIN M MCCARTNEY	E	GARNISHMENT	402.00
NATIONWIDE RETIREMENT	I	DEFERRED COMP	1,860.00
NE CHILD SUPPORT	E	CHILD SUPPORT	1,200.00
NE DEPARTMENT OF REVENUE	E	GARNISHMENT	55.00
PRINCIPAL	E	DENTAL	3,299.56
STATE OF NE	T	STATE TAXES	16,442.32
VISION SERVICE PLAN	E	EMPE VSP EYE	868.56
<u>ROAD FUND</u>			
NET PAYROLL			55,283.61
AMERICAN FAMILY LIFE	I	PREMIUMS	1,060.70
RETIREMENT PLANS AMERITAS	R	EMPE RET	8,813.89
BUFFALO CO TREASURER	I	PREMIUMS	2,998.50
FIRST CONCORD	E	FLEX FUNDS	697.84
FIRST NATIONAL BANK	T	FEDERAL TAXES	16,204.99
MADISON NATIONAL	I	PREMIUMS	144.51
MADISON NATIONAL	I	LT DISABILITY	105.45
NATIONWIDE RETIREMENT	R	DEFERRED COMP	272.50
PRINCIPAL	E	DENTAL	946.12
STATE OF NE	T	STATE TAXES	2,420.15
VISION SERVICE PLAN	E	EMPE VSP EYE	236.38
<u>WEED FUND</u>			
NET PAYROLL			5,061.08
RETIREMENT PLANS AMERITAS	R	EMPE RET	800.66
BUFFALO CO TREASURER	I	PREMIUMS	268.50
FIRST CONCORD	E	FLEX FUNDS	40.84
FIRST NATIONAL BANK	T	FEDERAL TAXES	1,623.80
MADISON NATIONAL	I	LT DISABILITY	3.54
PRINCIPAL	E	DENTAL	60.96
STATE OF NE	T	STATE TAXES	254.12

After discussion, it was determined that the Funds transfer agenda item was not necessary this month.

Moved by Morrow and seconded by Higgins to accept the Veterans Service Quarterly Reports ending September 30, 2021 and December 31, 2021. Upon roll call vote, the following Board members voted "Aye": Morrow, Higgins, Kouba, Loeffelholz, Lynch, Maendele and Klein. Motion declared carried.

Moved by Maendele and seconded by Kouba to authorize Chairman Klein to sign the agreement with Nebraska Department of Veterans' Affairs in order to allow County Veterans Service Office access to the Nebraska Department of Veterans' Affairs web based database. Upon roll call vote, the following Board members voted "Aye": Maendele, Kouba, Higgins, Loeffelholz, Lynch, Morrow and Klein. Motion declared carried.

Chief Deputy Dan Schleusener presented an overview of the bids that were opened on January 11, 2022 and a recommendation on the purchase of a Full Body Scanner System. Moved by Maendele and seconded by Lynch to accept the bid from Tek84 for the purchase of one Full Body Scanner System in the amount of \$159,000.00. Upon roll call vote, the following Board members voted "Aye": Maendele, Lynch, Higgins, Kouba, Loeffelholz, Morrow and Klein. Motion declared carried.

After review of the contract for Construction Manager of the 610 Central Project by Deputy County Attorney Hoffmeister, it was moved by Lynch and seconded by Morrow to authorize Chairman Klein to sign the contract with Beckenhauer Construction. Upon roll call vote, the following Board members voted "Aye": Lynch, Morrow, Higgins, Kouba, Loeffelholz, Maendele and Klein. Motion declared carried.

ZONING

Zoning Administrator Dennise Daniels was present for the following Zoning agenda items.

Chairman Klein opened the public hearing at 9:20 A.M. to determine if a special use permit should be cancelled that was previously filed by Ken Woitaszewski, on behalf of Woitaszewski Brothers Land Partnership. The special use permit was previously granted to operate a Class V Dairy Farm at property described as the North Half of Section Thirteen (13), Township Twelve (12) North, Range Fourteen (14) West of the Sixth Principal Meridian, Buffalo County, Nebraska. Deputy County Attorney Hoffmeister reviewed the special use permit that was filed in 2008 and Lynne Werner, of Flying W, LLC addressed the Board. No one else addressed the Board and Chairman Klein closed the hearing at 9:26 A.M. Moved by Loeffelholz and seconded by Higgins to cancel the special use permit with the following Resolution 2008-22A. Upon roll call vote, the following Board members voted "Aye": Loeffelholz, Higgins, Kouba, Lynch, Maendele, Morrow and Klein. Motion declared carried.

RESOLUTION 2008-22A

WHEREAS, on January 22, 2008, Ken Woitaszewski on behalf of Woitaszewski Brothers filed an Application for Special Use Permit, with Buffalo County Clerk and/or Zoning Administrator, application to operate a Class V Livestock Facility, inventoried on the zoning records of Buffalo County as Permit #2008-006. This operation was to be situated on the following legal description:

A tract of land being part of the North Half (N1/2) of Section Thirteen (13), Township Twelve (12) North, Range Fourteen (14) West of the Sixth Principal Meridian, Buffalo County, Nebraska, more particularly described as follows: Referring to the Northeast corner of said Section 13 and assuming the East line of said Section 13 as bearing S 01°31'51" W and all bearings contained herein are relative thereto; thence S 01°31'51" W on the aforesaid East line a distance of 437.51 feet to the ACTUAL PLACE OF BEGINNING; thence continuing S 01°31'51" W on the aforesaid East line a distance of 790.78 feet; thence S 16°10'22" W a distance of 554.97 feet; thence S 10°15'35" W a distance of 554.97 feet; thence S 84°20'50" W a distance of 961.31 feet; thence S 74°05'45" W a distance of 961.31 feet to a point on the South line of the North Half of said Section 13; thence S 89°38'43" W on the aforesaid South line a distance of 247.92 feet; thence N 66°12'08" W a distance of 1365.95 feet; thence N 80°47'20" W a distance of 1365.95 feet; thence N 25°18'31" E a distance of 918.99 feet; thence N 15°30'34" E a distance of 918.99 feet to a point 150.0 feet southerly of, as measured at right angles to, the North line of the Northwest Quarter said Section 13; thence N 89°11'02" E parallel with and 150.0 feet southerly of the aforesaid North line a distance of 1744.57 feet; thence N 89°52'40" E parallel with and 150.0 feet southerly of the North line of the Northeast Quarter of said section a distance of 1241.68 feet; thence S 74°34'38" E a distance of 704.58 feet; thence S 82°05'10" E a distance of 704.58 feet to the place of beginning. Containing 223.58 acres, more or less, hereinafter referred to as the "subject property".

WHEREAS, on February 21, 2008, the Buffalo County Planning and Zoning Commission conducted a public hearing on such Special Use Permit and on a 7-2 vote with none absent, voted to forward this application to the Buffalo County Board of Supervisors, now Commissioners, with a favorable recommendation, and

WHEREAS, on March 25, 2008, the Buffalo County Board of Supervisors, now Commissioners, held a public hearing on this Special Use Permit and by simple majority, approved the applicant's Special Use Permit to construct a Class V livestock confinement facility on the subject property, as submitted in the application as Plan B, or amended as Plan BZ, subject to the conditions set forth in Resolution 2008-22 and

WHEREAS, on or about January 1, 2022, The Buffalo County Zoning Administrator was made aware that no substantial and continuous construction of the use/structures had been made within the allotted time, as required under Resolution 2008-22.

WHEREAS, as provided by Buffalo County's Zoning Regulation Resolution, this Board reserves the power to revoke any special use permit that has been issued by this Board for the failure to comply with such terms, conditions and requirements, or take such other action as it may deem necessary to obtain compliance. If the Zoning Administrator or any two members of this Board find at any time

that the terms, conditions and requirements of this special use permit have not been complied with, or that any phase thereof has not been completed within the time required under said special use permit or any amendment thereto, the Zoning Administrator or any two members of this Board shall report this fact to the County Commissioners, and thereafter this Board may conduct review of compliance by public hearing with notice given to applicant(s) and/or entity using the subject property. Following such public meeting this Board may take any action it may deem necessary to secure compliance including revocation and termination of this special use permit.

WHEREAS, on January 25, 2022, the Buffalo County Board of Commissioners held a public hearing, after providing notice, to determine whether this Board should cancel the Special Use Permit authorized in Resolution 2008-22, due to the failure to comply with said terms, conditions and requirements, as set out in said Resolution.

WHEREAS, following hearing on the issue, this Board determines that no construction activity commenced within the timelines stated in Resolution 2008-22, and this permit should be cancelled for this reason.

NOW THEREFORE, BE IT RESOLVED THAT BY THE BUFFALO COUNTY BOARD OF COMMISSIONERS by a majority vote of its members for the foregoing reasons, cancels the Special Use Permit, inventoried as Permit #2008-006, that was granted the Special Use Requested all as set out in Resolution 2008-22.

REGULAR AGENDA

Weed Superintendent Bret Stubbs was present to review the Weed Department Annual State Reports. Moved by Lynch and seconded by Maendele to authorize Chairman Klein to sign the reports as presented to be filed with the Nebraska Department of Agriculture. Upon roll call vote, the following Board members voted "Aye": Lynch, Maendele, Higgins, Kouba, Loeffelholz, Morrow and Klein. Motion declared carried.

Chairman Klein reviewed the following correspondence. Federal Aviation Administration sent a postcard stating they conducted an aeronautical study concerning a project in Mason City, NE. Nebraska Emergency Management Agency sent a letter regarding the modification of completion requirements for local emergency operations plans and a letter with award nominations. JEO Consulting Group correspondence regarding the Central Platte Natural Resources District Hazard Mitigation Plan Update Round Two public meeting dates and times. City of Kearney sent notification regarding the annexation of a portion of Northeast Public Service Addition. Nebraska Department of Transportation (NDOT) sent the monthly status report update on the Poole South project.

Deputy County Attorney Hoffmeister reviewed the contract for a road improvement project on Frontage Road south of M Street and I-80 overpass. Mitch Humphrey also addressed the Board. After discussion, it was moved by Morrow and seconded by Kouba to authorize Chairman Klein to sign the road improvement project contract with Barton E. Langenburg, agent for KDIVER, LLC. Upon roll call vote, the following Board members voted "Aye": Morrow, Kouba, Higgins, Loeffelholz, Lynch, Maendele and Klein. Motion declared carried.

After discussion it was moved by Loeffelholz and seconded by Lynch to accept the filed petition to pave a portion of 56th Street to Evergreen Road. No further action was taken at this time. Upon roll call vote, the following Board members voted "Aye": Loeffelholz, Lynch, Higgins, Kouba, Maendele, Morrow and Klein. Motion declared carried.

Moved by Higgins and seconded by Lynch to approve the following January 2022 vendor claims submitted by the County Clerk. Upon roll call vote, the following Board members voted "Aye": Higgins, Lynch, Kouba, Loeffelholz, Maendele, Morrow and Klein. Motion declared carried.

GENERAL FUND			
ADVANCED CORRECTIONAL HEALTHCARE	MC	MEDICAL	12,169.76
AKRS EQUIPMENT RAVENNA JOHN DEERE	S	SVC	1,330.70
ALL MAKES AUTO SUPPLY	SU	PARTS	1,704.90
AMAZON CAPITAL SERVICES	E	EXPENSES	320.32
AMERICAN ELECTRIC COMPANY	SU	PARTS	1.50
MANDI J AMY	RE	REIMBURSE	45.00
ANDERSEN WRECKING COMPANY	SU	PARTS	50.00
APPLE MARKET	S	SUPPLIES	17.20
NATHAN AREHART	RE	REIMBURSE	45.00
AT&T MOBILITY	S	CELL SVC	2,196.65
ATS	S	SVC	360.88
AVCOMM SOLUTIONS INC	EQ	EQUIP	13.05
BANKWEST OF KANSAS	S	SVC	466.00
RICHARD BEECHNER	E	MH BOARD	375.00
BENTLEY HAYS LLP	S	LEGAL	1,462.50
BRAD W BIGELOW	E	MH BOARD	225.00
BLACK HILLS ENERGY	U	UTILITY	401.18
BLUE360 MEDIA LLC	E	SUBSCRIPTION	428.58
BOYS TOWN	S	JUV SVCS	1,604.69
BRAD RODGERS MD FAMILY PRACTICE	MC	MEDICAL	171.18

JONATHAN R BRANDT	S	LEGAL	5,703.38
NATHAN BRECHT	RE	REIMBURSE	45.00
CHARLES BREWSTER	S	LEGAL	1,743.75
D. BRANDON BRINEGAR	RE	REIMBURSE	14.41
BRUNER FRANK SCHUMACHER, LLC	S	LEGAL	5,813.11
BSBB, LLP	RT	RENT	290.00
BUFFALO CO BOARD OF COMMISSIONERS	RE	REIMBURSE	14.00
BUFFALO CO COMMUNITY PARTNERS	S	JUV SVC	690.46
BUFFALO CO ATTORNEY	E	DUBBING FEES	317.00
BUFFALO CO ATTORNEY'S OFFICE	RE	REIMBURSE	239.65
BUFFALO CO COURT	RE	REIMBURSE	22.52
BUFFALO CO COURT	RE	REIMBURSE	2,875.68
BUFFALO CO FACILITIES	E	POSTAL FEE	90.00
BUFFALO CO PUBLIC DEFENDER	RE	REIMBURSE	30.00
BUFFALO CO SHERIFF	E	SVC FEES	2,010.12
BUILDERS WAREHOUSE INC	SU	SUPPLIES	1,326.43
CANON SOLUTIONS AMERICA	S	MAINTENANCE	162.90
MICHAEL D CARPER	S	LEGAL	857.30
RYAN C CARSON	RE	REIMBURSE	45.00
CASH WA DISTRIBUTING	SU	SUPPLIES	27.80
CENTRAL MEDIATION CENTER	S	JUV SVC	540.00
CENTRAL NE CREMATION	E	TRANSPORT	250.00
CENTRAL NE REPORTING	E	TRANSCRIPTION	708.32
CENTRAL STATES INVESTMENTS	RT	RENT	210.00
CENTURY LUMBER CENTER	SU	SUPPLIES	426.22
CENTURY 21 MIDLANDS	RT	RENT	210.00
CHARLESWORTH CONSULTING	E	CONSULTING	1,050.00
CHARM-TEX INC	SU	SUPPLIES	4,445.00
CHARTER COMMUNICATIONS	S	TELE SVCS	466.98
DR H L CHRISTMAN OPTOMETRIST	MC	MEDICAL	1,166.00
JENNIFER CHURCH	RE	REIMBURSE	45.00
CITY OF KEARNEY	U	UTILITIES	2,624.60
CITY OF KEARNEY	RE	REIMBURSE	1,500.00
CITY OF KEARNEY	E	EXPENSES	94,419.79
CLERK OF THE DISTRICT COURT	E	COURT COSTS	1,398.76
CNA SURETY	E	NOTARY FEE	120.00
COCHRAN LAW PC	S	LEGAL	2,455.00
COMFY BOWL	EQ	EQUIP	100.00
COMPASS FAMILY SUPPORT SERVICES	S	JUV SVC	585.00
CONSOLIDATED MANAGEMENT CO	S	FOOD SVC	25,455.22
CONSTRUCTION RENTAL	EQ	EQUIP RENTAL	652.50
COPYCAT PRINTING CENTER	E	PRINTING	1,112.14
COUNTRY PARTNERS COOPERATIVE	F	PROPANE	270.00
COUNTRYSIDE MOBILE PARK	R	RENTAL	210.00
DR. ANTHONY TATMAN	S	PSYCH TEST	25.00
CULLIGAN OF KEARNEY	S	SVC	1,420.30
CUSTER CO SHERIFF	E	SVC FEE	43.96
WENDY C CUTTING	E	TRANSCRIPTION	1,004.75
DAN'S SANITATION	S	SVC	16.00
DENNISE DANIELS	RE	REIMBURSE	45.00
DAS ST ACCOUNTING	S	SVC	41.60
DAS STATE ACCTNG-CENTRAL FINANCE	S	NETWORK SVC	1,340.00
DAWSON CO SHERIFF'S OFFICE	S	SVC FEE	35.70
DAWSON PUBLIC POWER DISTRICT	U	UTILITIES	8,289.27
DAMON DEEDS	RE	REIMBURSE	45.00
DEPARTMENT OF CORRECTIONAL SERVICES	MC	MEDICAL	1,522.63
DEPT OF PATHOLOGY-ST LOUIS UNIV	MC	MEDICAL	331.00
DEWALD DEAVER L'HEUREUX LAW FIRM	S	LEGAL	2,770.00
DIER, OSBORN & COX, P.C., L.L.O.	S	LEGAL	165.00
DONKEY TOWING & TRANSFER	S	TOWING	422.00
DOUGLAS CO SHERIFF	E	SVC FEE	24.13
DOWHY TOWING & RECOVERY	S	TOWING	100.00
BRANDON J. DUGAN	RE	REIMBURSE	10.35
EAKES OFFICE SOLUTIONS	SU	SUPPLIES	2,202.36
SHAWN EATHERTON	RE	REIMBURSE	45.00

EDUCATIONAL SERVICE UNIT NO 10	S	SUPPORT	20,625.95
ELECTRONIC SYSTEMS	S	SVC	2,367.00
ENTERPRISE ELECTRIC KEARNEY	SU	SUPPLIES	1,190.00
FAMILY PRACTICE ASSOCIATES	MC	MEDICAL	4,808.00
MARSHA FANGMEYER, ESQ.	S	LEGAL	465.00
FARMERS COOPERATIVE ASSOCIATION	F	FUEL	48.68
PAUL FARRELL	RE	REIMBURSE	45.00
FBINAA-IOWA/NE JOINT CHAPTER	E	TRAINING	300.00
KARI FISK	RE	REIMBURSE	45.00
FLEETPRIDE	E	SOFTWARE	2,690.00
KEISHA FRIES	E	WITNESS	20.00
FRONTIER	S	TELE SVCS	2,725.41
FYE LAW OFFICE	S	LEGAL	5,040.60
GARRETT TIRES & TREADS	S	REPAIRS	2,469.12
CYNTHIA GEMBALA HUGG	E	TRANSCRIPTION	195.25
LANNY GERDES	RT	RENT	250.00
R GARRETT GOODWIN	RE	REIMBURSE	39.20
GRAHAM TIRE	S	REPAIRS	1,686.70
ZACHARY K GRAY	S	LEGAL	735.00
GWORKS	E	SUBSCRIPTION	4,475.00
HALL CO DISTRICT COURT	E	EXPENSES	38.75
HALL CO SHERIFF'S OFFICE	S	SVC FEES	77.60
NE CENTRAL TELEPHONE CO	S	TELE SVC	330.92
JOYCE HASSELBALCH	E	TRANSCRIPTION	138.00
ANDREW W HOFFMEISTER	RE	REIMBURSE	45.00
HOLMES PLUMBING & HEATING	EQ	EQUIP	1,157.34
HOMETOWN LEASING	EQ	PRINTER LEASE	5,916.02
HORNER, LIESKE, MCBRIDE & KUHL	E	CREMATION	4,850.00
LISA R HUERTA	RE	REIMBURSE	45.00
INNOVATIVE MAINTENANCE SYSTEMS	E	SOFTWARE	418.39
INTEGRATED SECURITY SOLUTIONS	S	SVC	1,000.00
INTERSTATE ALL BATTERY CENTER	SU	BATTERIES	108.00
JACK'S UNIFORMS AND EQUIPMENT	EQ	EQUIP	1,175.62
JACOBSEN ORR LAW FIRM	S	LEGAL	9,214.43
JOHN DEERE FINANCIAL	EQ	EQUIP	69.97
JOHNSTONE SUPPLY	SU	SUPPLIES	273.93
ALEYAH JORDAN	E	WITNESS	20.00
JUSTICE WORKS LLC	E	SUBSCRIPTION	182.00
KEARNEY HOUSING AGENCY	RT	RENT	480.00
KEARNEY WINNELSON CO	SU	SUPPLIES	946.75
KELLY KENNEDY	RE	REIMBURSE	25.00
NICK KILLOUGH	RE	REIMBURSE	45.00
JEFFREY C KNAPP	S	LEGAL	127.83
DOUG KRAMER	RE	REIMBURSE	45.00
KRONOS	S	MAINTENANCE	1,102.50
LEE ENTERPRISES LINCOLN JOURNAL STAR	A	PUBLISHING	2,440.61
LIESKE, LIESKE & ENSZ	S	LEGAL	1,203.00
STEPHEN G LOWE	E	MH BOARD	581.25
JOHN MARSH	RE	REIMBURSE	45.00
LYNN MARTIN	RE	REIMBURSE	45.00
MASTERS TRUE VALUE	SU	SUPPLIES	54.58
MATTHEW BENDER & CO	SU	SUPPLIES	2,292.99
SHARON MAULER	RE	REIMBURSE	45.00
JENNIFER R MCCARTER REPORTING	E	TRANSCRIPTION	82.50
MEAD LUMBER	SU	SUPPLIES	167.94
MECHANICAL SALES, INC	S	REPAIRS	1,227.50
MICHAEL MEFFERD	RE	REIMBURSE	45.00
MENARDS - KEARNEY	SU	SUPPLIES	2,513.41
CARSON K MESSERSMITH	S	LEGAL	5,287.50
MANDY M MEYER	E	MH BOARD	150.00
MICROFILM IMAGING SYSTEMS	EQ	EQUIP RENTAL	730.00
MID NE AGGREGATE	C	WHITE ROCK	920.68
MID-STATES ORGANIZED CRIME	E	MEMBERSHIP	200.00
MIDDLETON ELECTRIC	S	SVC	2,164.77
MIDWEST CONNECT	S	MAIL SVC	15,042.75

MIPS INC.	S	SUPPORT	5,742.42
MIRROR IMAGE CAR WASH	S	MAINTENANCE	151.19
MOONLIGHT CUSTOM SCREENPRINT	S	SCREENPRINTING	63.00
NACO	E	REGISTRATION	200.00
NACO PLANNING AND ZONING	E	REGISTRATION	40.00
NAVSURFWARCENDIV CRANE	EQ	EQUIP	1,800.00
NE ASSN OF CO CLERKS,REG DEEDS, ELEC	E	REGISTRATION	225.00
NE ASSN OF CO ASSESSORS	E	REGISTRATION	60.00
NE GENERATOR SERVICE	S	SVC	733.00
NE HEALTH & HUMAN SERVICES	E	PATIENT SVCS	995.25
NE LAW ENFORCEMENT	E	TRAINING	135.00
NE OPERATION LIFESAVER	D	DUES	300.00
NE PUBLIC POWER DISTRICT	U	UTILITIES	620.00
NE PUBLIC POWER DISTRICT	U	UTILITIES	12,505.37
NE SECRETARY OF STATE	E	NOTARY	30.00
NE INTERACTIVE LLC	E	COPIES	143.50
OPTK NETWORKS	S	INTERNET	1,203.24
ROBERT NELSON	RE	REIMBURSE	45.00
KRISTI NEWMAN	RE	REIMBURSE	42.79
NOLLER ELECTRIC	S	SVC	2,067.53
NORTHEAST NE JUVENILE SERVICES	S	JUV SVCS	5,425.00
NORTHWESTERN ENERGY	U	UTILITIES	9,277.93
NP REALTY	RT	RENT	290.00
OWENS EDUCATIONAL SERVICES	S	JUV SVCS	1,271.56
PARKER GROSSART BAHENSKY BEUCKE	S	LEGAL	566.84
NATE PEARSON	RE	REIMBURSE	45.00
PELL REPORTING	S	SVC FEES	103.76
PLATTE VALLEY COMMUNICATIONS	EQ	EQUIPMENT	1,073.95
PLATTE VALLEY DENTAL CLINIC	MC	MEDICAL	2,087.00
POLICE OFFICERS ASSOCIATION	D	DUES	555.00
POWER DMS, INC	E	TRAINING	6,151.56
PSYCHOLOGICAL RESOURCES	S	PSYCH TEST	405.00
QUILL CORPORATION	SU	SUPPLIES	1,568.72
SADIE QUINTANA	E	WITNESS FEE	20.00
KANE M RAMSEY	RE	REIMBURSE	45.00
RAVENNA SANITATION LLC	S	SVC	1,329.95
REGION III BEHAVIORAL HEALTH SVCS	S	SVC	38,999.06
RUDOLPH LAW	S	LEGAL	956.25
RUN-N-IRON CUSTOMIZING	EQ	EQUIP	650.00
SHERRY K FOLEY	RT	RENT	290.00
RYAN SAALFELD	RE	REIMBURSE	45.00
SCHANEMAN PROPERTIES	RT	RENT	210.00
MARY K SCHNEIDER	E	WITNESS	77.33
KIRK SCOTT	RE	REIMBURSE	45.00
SEWARD CO SHERIFF	S	SVC FEES	52.02
SHERWIN WILLIAMS	SU	SUPPLIES	295.84
SHREDDING SOLUTIONS	S	SHREDDING	45.00
TRENTON SNOW, LLC	RT	EQUIP RENTAL	1,000.00
SOLID WASTE AGENCY LANDFILL	E	LANDFILL	11.15
STAMM ROMERO & ASSOC	S	LEGAL	7,732.50
STATE OF NEBR PROBATION DIST 9	AP	BUDGET	3,585.99
STEHLIK LAW FIRM PC	S	LEGAL	632.50
THOMAS S STEWART	S	LEGAL	2,435.00
STITCH 3 LLC	S	SVC	222.00
SUNBELT RENTALS	S	REPAIRS	1,235.36
MICHAEL J SYNEK	S	LEGAL	1,374.33
SHAWN TALLON	RE	REIMBURSE	45.00
THE LOCKMOBILE	E	KEYS	4.90
THOMSON REUTERS - WEST	E	SUBSCRIPTION	3,730.36
THOMSON REUTERS-WEST	E	SUBSCRIPTION	750.11
THOMSON REUTERS - WEST	E	SUBSCRIPTION	638.65
TONNIGES & ASSOCIATES P.C.	E	CONTRACT	14,325.00
TURNER BODY SHOP OF KEARNEY	R	DEDUCTIBLE	1,069.95
REBECCA TVRDIK ANDERSON	S	LEGAL	1,687.50
TYE & ROWLING, PC, LLO	S	LEGAL	2,796.80

TYLER TECHNOLOGIES	E	SOFTWARE	1,347.00
U S POSTMASTER	E	POSTAGE	290.00
U S POSTMASTER	E	POSTAGE	1,565.00
U.S. BANK	E	EXPENSES	6,699.41
USA COMMUNICATION	U	INTERNET	1,413.82
U.S DEPARTMENT OF AGRICULTURE	AP	BUDGET	10,790.78
USPS - HASLER	E	POSTAGE	1,500.00
ESTRELLA VERA CHAVEZ	RE	REIMBURSE	45.00
VERIZON	S	GPS	720.10
VERIZON WIRELESS	S	TELE SVC	631.28
VILLAGE OF ELM CREEK	U	INTERNET	44.98
VILLAGE OF MILLER	U	UTILITIES	25.00
VILLAGE UNIFORM	EQ	UNIFORM	74.72
VOIGT LAW OFFICE	S	LEGAL	135.00
THE WALDINGER CORPORATION	S	MAINTENANCE	5,872.55
WELLS FARGO	E	EXPENSES	99.00
WELLS FARGO	E	EXPENSES	627.00
WELLS FARGO	E	EXPENSES	116.24
WELLS FARGO	E	EXPENSES	311.81
WILKE'S TRUE VALUE	SU	SUPPLIES	87.30
WILKINS ARCHITECTURE DESIGN	S	SVC	4,900.00
MELISSA L WILLIS	RE	REIMBURSE	45.00
JEFF WIRTH	RE	REIMBURSE	120.00
DEAN WISEMAN	E	WITNESS	20.00
WPCI	S	SCREENING	95.00
MELANIE R YOUNG	RE	REIMBURSE	45.00
ERIC ZIKMUND	RE	REIMBURSE	45.00
ROAD FUND			
ACE HARDWARE & GARDEN CENTER	SU	TOOLS	27.99
ALL MAKES AUTO SUPPLY	SU	PARTS	31.34
AUSSIE HYDRAULICS LLP	S	REPAIRS	127.64
ARNOLD MOTOR SUPPLY/AUTO VALUE PART	SU	PARTS	3,087.81
BOSSELMAN ENERGY	F	FUEL	838.48
BUILDERS WAREHOUSE	SU	TOOLS	69.97
CARQUEST AUTO PARTS	SU	PARTS	1,309.71
CENTRAL HYDRAULIC SYSTEM & EQUIP CO	S	REPAIRS	703.36
CHS AGRI SERVICE CENTER	F	FUEL	36.54
CFP-C-T	F	FUEL	65.00
COMFY BOWL	EQ	EQUIP	95.00
CONSTRUCTION RENTAL	EQ	EQUIP RENTAL	26.00
ED BROADFOOT & SONS SAND & GRAVEL	G	GRAVEL	21,884.23
FARMERS CO-OP ASSOCIATION	F	FUEL	230.01
FASTENAL COMPANY	SU	SUPPLIES	17.13
GARRETT TIRES & TREADS - KEARNEY	EQ	EQUIP	4,659.97
GRAHAM TIRE CO	S	REPAIR	49.62
INLAND TRUCK PARTS & SERVICE CO	S	REPAIRS	1,336.96
KELLY SUPPLY COMPANY	S	REPAIRS	127.38
JOHN WILLIAM KING	R	RETIREMENT	34.62
LEE ENTERPRISES LINCOLN JOURNAL STAR	A	PUBLISHING	342.94
MATHESON TRI-GAS INC	S	REPAIRS	80.00
MENARDS	SU	SUPPLIES	550.95
NE ASSN CO ENG, HWY SUPER & SURVEY	E	REGISTRATION	210.00
NE TRUCK CENTER	S	REPAIRS	950.78
NOVUS WINDSHIELD REPAIR	S	REPAIR	50.00
OAK CREEK ENGINEERING	S	ENGINEERING	8,700.00
PLATTE VALLEY AUTO	S	REPAIRS	246.42
POSTLE INDUSTRIES	SU	SUPPLIES	170.87
POWERPLAN-MURPHY TRACTOR	S	REPAIRS	4,419.10
ROCKMOUNT RESEARCH & ALLOYS INC	SU	SUPPLIES	323.54
SANDHILL PLASTICS	SU	SUPPLIES	158.84
TITAN MACHINERY-LEXINGTON	EQ	EQUIP	2,570.67
TRAUSCH DYNAMICS	S	REPAIRS	880.89
TRUCK CENTER COMPANIES	S	REPAIRS	1,130.15
U.S. BANK	E	EXPENSES	538.84
VISITOR'S PROMOTION			

KEARNEY VISITOR'S BUREAU	E	EXPENSES	56,318.00
VISITOR'S IMPROVEMENT			
KEARNEY VISITOR'S BUREAU	E	EXPENSES	56,318.00
DEEDS PRESERVATION & MODERNIZATION			
MIPS INC.	S	PRESERVATION	249.00
HEALTH INSURANCE FUND			
BCBS HEALTH CLAIM EXPENSE	I	HEALTH	266,969.96
HM LIFE MELLON GLOBAL CASH MGNT	I	HEALTH	46,637.80
VETERAN'S RELIEF			
CO VETERANS AID FUND	E	EXPENSES	2,414.20
INHERITANCE TAX			
CDW GOVERNMENT	E	RADIO PROJECT	1,064.78
PLATTE VALLEY COMMUNICATIONS	E	RADIO PROJECT	56,307.88
SUNNY COMMUNICATIONS	E	RADIO PROJECT	18,980.00
U.S. BANK	E	RADIO PROJECT	29.96
WEED DISTRICT FUND			
NE WEED CONTROL ASSOC	E	REGISTRATION	330.00
NE WEED CONTROL-REGION 4	E	REGISTRATION	15.00
PLATTE VALLEY WEED MGMT AREA	E	REGISTRATION	250.00
U.S. BANK		EXPENSES	80.00
911 EMERGENCY SERVICE			
BIDDLE CONSULTING GROUP	S	SVC	699.00
CENTURYLINK	U	911 SVC	1,900.74
CENTURYLINK	U	911 SVCS	1,709.48
FRONTIER	U	911 SVCS	1,057.20
FRONTIER COMMUNICATIONS CORP	U	911 SVCS	518.30
NE CENTRAL TELEPHONE CO	U	911 SVCS	109.99
LANGUAGE LINE SERVICES	U	911 SVCS	184.36
PLATTE VALLEY COMMUNICATIONS, INC.	S	REPAIR	1,751.88
USA COMMUNICATION	U	911 SVCS	582.00

Chairman Klein called for Citizen's forum. Paul Hazard addressed the Board in regards to concerns about the petition filed to pave a portion of 56th Street to Evergreen Road. Hazard's concerns on that portion of road are for safety, he noted the high traffic count and the amount of youth drivers who live in the area. Hazard also asked if COVID grant funds could be used and if this road could be included in the one and six year road plan. No one else addressed the Board.

Moved by Higgins and seconded by Lynch to enter into Executive Session at 9:56 A.M. for the purpose of discussion on a pending litigation offer and for the protection of the public's interest. In addition to the Board members responding to roll call, County Attorney Eatherton, Deputy County Attorney Fisk and Board Administrator Lynn Martin were present. Joining them via zoom was Brandy Johnson, legal counsel with NIRMA. Upon roll call vote, the following Board members voted "Aye": Higgins, Lynch, Kouba, Loeffelholz, Maendele, Morrow and Klein. Motion declared carried.

Moved by Maendele and seconded by Loeffelholz to move out of Executive Session at 10:05 A.M. and resume the open meeting. Upon roll call vote, the following Board members voted "Aye": Maendele, Loeffelholz, Higgins, Kouba, Lynch, Morrow and Klein. Motion declared carried.

Moved by Morrow and seconded by Loeffelholz to approve the settlement claims per NIRMA. Upon roll call vote, the following Board members voted "Aye": Morrow, Loeffelholz, Higgins, Kouba, Lynch, Maendele and Klein. Motion declared carried.

Chairman Klein called on each Board member present for committee reports and recommendations.

Chairman Klein asked if there was anything else to come before the Board at 10:14 A.M. before he declared the meeting adjourned until the regular meeting at 9:00 A.M. on Tuesday, February 8, 2022.

ATTEST:

Ivan Klein, Chairman
Buffalo County Board of Commissioners

Janice I. Giffin
Buffalo County Clerk

(SEAL)

JANUARY 28, 2022 PAYROLL

<u>GENERAL FUND</u>			
NET PAYROLL			294,547.40
AMERICAN FAMILY LIFE	I	PREMIUMS	1,201.59
RETIREMENT PLANS AMERITAS	R	EMPE RET	49,393.75
BUFFALO CO TREASURER	I	PREMIUMS	122,505.00
CREDIT MANAGEMENT	E	GARNISHMENT	133.32
EMPOWER RETIREMENT	R	DEFERRED COMP	1,125.00
FIRST CONCORD	E	FLEX FUNDS	4,877.10
FIRST NATIONAL BANK	T	FEDERAL TAXES	101,474.61
KEARNEY UNITED WAY	E	DONATIONS	114.67
MADISON NATIONAL	I	PREMIUMS	1,001.09
MADISON NATIONAL	I	LT DISABILITY	293.95
ERIN M MCCARTNEY	E	GARNISHMENT	402.00
NATIONWIDE RETIREMENT	I	DEFERRED COMP	1,860.00
NE CHILD SUPPORT	E	CHILD SUPPORT	1,200.00
NE DEPARTMENT OF REVENUE	E	GARNISHMENT	55.00
PRINCIPAL	E	DENTAL	3,300.34
STATE OF NE	T	STATE TAXES	17,136.41
VISION SERVICE PLAN	E	EMPE VSP EYE	869.64
<u>ROAD FUND</u>			
NET PAYROLL			54,362.94
AMERICAN FAMILY LIFE	I	PREMIUMS	1,060.70
RETIREMENT PLANS AMERITAS	R	EMPE RET	8,666.58
BUFFALO CO TREASURER	I	PREMIUMS	2,998.50
FIRST CONCORD	E	FLEX FUNDS	697.84
FIRST NATIONAL BANK	T	FEDERAL TAXES	15,852.90
MADISON NATIONAL	I	PREMIUMS	146.34
MADISON NATIONAL	I	LT DISABILITY	105.51
NATIONWIDE RETIREMENT	R	DEFERRED COMP	272.50
PRINCIPAL	E	DENTAL	946.21
STATE OF NE	T	STATE TAXES	2,341.80
VISION SERVICE PLAN	E	EMPE VSP EYE	236.65
<u>WEED FUND</u>			
NET PAYROLL			5,061.03
RETIREMENT PLANS AMERITAS	R	EMPE RET	800.66
BUFFALO CO TREASURER	I	PREMIUMS	268.50
FIRST CONCORD	E	FLEX FUNDS	40.84
FIRST NATIONAL BANK	T	FEDERAL TAXES	1,623.80
MADISON NATIONAL	I	LT DISABILITY	3.55
PRINCIPAL	E	DENTAL	61.00
STATE OF NE	T	STATE TAXES	254.12

SHARON K. MAULER
CLERK OF THE DISTRICT COURT

MONTHLY FEE REPORT
for the Month of January, 2022

ACCOUNT DESCRIPTION	TOTAL AMOUNT
Filing Fee, Civil	805.00
Filing Fee, Criminal	25.00
Filing Fee, Judgment	175.00
Filing Fee, Criminal Appeal	00.00
Complete Records	719.00
Issuance of Writ	5.00
Reg. Work Comp. Judgment	00.00
Copies	49.75
Postage	00.00
Fax Fees	00.00
Publishing Fees	00.00
Transcript Fee/Seal Cert	2.00
Bad Check Fee	20.00
Bond 10%	925.00
Bond Forfeiture	00.00
County Court Fees	2772.85
Passport Processing Fee	2450.00

Grand Total	\$ 7948.60
Total for January, 2022	7948.60
Total for January	7948.60

STATE OF NEBRASKA:
COUNTY OF BUFFALO:

I, Sharon K. Mauler, the duly elected and qualified Clerk of District Court in and for said county, do hereby certify that the foregoing report is true and correct to the best of my knowledge and belief.



Sharon K. Mauler

SHARON K. MAULER
Clerk of the District Court

Subscribed and sworn to before me the 1 day of February, 2022.

Cheryl S. Stabenow

Notary Public

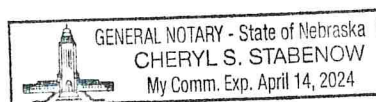

received
2-1-2022

January 2022

Ivan Klein, Chair
Buffalo County Board of Commissioners
1512 Central Ave
Kearney, NE 68847

Dear Commissioner Ivan Klein:

Nebraska Extension is pleased to continue a strong tradition of making a difference in the lives of individuals, families, businesses and communities in Buffalo County! Our programs address issues that Nebraskan's have identified as being important to them.

Enclosed you will find local Extension programming and financial summaries for 2021. Specific items include 1) Summary of 2020-21 budget expenditures, 2) Current fiscal year 2021-22 budget, 3) County Impact Report, 4) Brief program summary for each educator and assistant/associate, and 5) Samples of 4-H newsletters and news articles.

Thank you for continuing to invest in Nebraska Extension as a local collaborative partner. We strive to be great stewards of resources and work hard every day to demonstrate a strong return on your investment. As you know, Extension educators and assistants live, work and engage with people in your local and area communities. We look forward to making a difference in the lives of Nebraskans together with you!

Sincerely,



Shane Bendfeldt
President
Buffalo County Extension Board



Kerry Elsen
Lead Educator
Nebraska Extension in Buffalo County

Enclosure

BUFFALO
CURRENT EXPENDITURES FOR JUNE 30, 2021
(0100) COUNTY GENERAL

		Budget Adopted	Expenditures	Year-to-date Expenditures	Budget Remaining	Percent Used

645-00	COOPERATIVE EXTENSION					
1-0100	OFFICIAL'S SALARY	.00	.00	.00	.00	0%
1-0200	DEPUTY'S SALARY	.00	.00	.00	.00	0%
1-0301	EXTENSION ASSISTANT	20,000.00	.00	4,350.75	15,649.25	22%
1-0305	CLERICAL SALARY	68,153.60	5,276.80	68,120.64	32.96	100%
1-0405	CLERICAL P/T SALARY	.00	.00	.00	.00	0%
1-0408	PART-TIME SALARY SPRAYING	.00	.00	.00	.00	0%
1-0423	AG AGT - AIDES P/T SAL	22,610.00	1,040.00	7,007.00	15,603.00	31%
1-0500	OVERTIME	3,500.00	.00	1,158.85	2,341.15	33%
1-0801	WORKMANS COMPENSATION	.00	.00	.00	.00	0%
1-0802	HEALTH INSURANCE	.00	.00	.00	.00	0%
1-0803	LIFE (MADISON NATIONAL)	.00	.00	.00	.00	0%
1-0804	LIFE (GREAT WEST)	.00	.00	.00	.00	0%
1-0900	RETIREMENT	6,127.00	356.18	4,676.33	1,450.67	76%
1-1000	OASI	6,943.00	458.82	5,590.73	1,352.27	81%

	CLASS TOTAL	127,333.60	7,131.80	90,904.30	36,429.30	71%
2-0100	POSTAL SERVICES	2,500.00	94.55	922.29	1,577.71	37%
2-0200	TELEPHONE SERVICE	1,200.00	.00	1,200.00	.00	100%
2-0900	GEN FINANCE/ADMIN EXPENSE	.00	.00	.00	.00	0%
2-1200	OFFICE EQUIPMENT REPAIR	.00	.00	.00	.00	0%
2-1601	CAR REPAIRS	500.00	.00	190.44	309.56	38%
2-1704	MILEAGE	4,000.00	.00	290.00	3,710.00	7%
2-1708	BOARD MEMBERS EXPENSE	250.00	.00	116.74	133.26	47%
2-1801	DUES, SUBSCRIPTIONS & REG.	350.00	8.43	515.96	165.96-	147%
2-2515	CONTRACTUAL SERVICES	.00	.00	.00	.00	0%
2-9900	MISCELLANEOUS	500.00	.00	219.93	280.07	44%

	CLASS TOTAL	9,300.00	102.98	3,455.36	5,844.64	37%
3-0100	RENTAL EXPENSES	.00	.00	.00	.00	0%
3-0101	OFFICE SUPPLIES	3,500.00	2,173.72	2,825.55	674.45	81%
3-0124	PROGRAM SUPPLIES	3,500.00	950.82	2,000.12	1,499.88	57%

	CLASS TOTAL	7,000.00	3,124.54	4,825.67	2,174.33	69%
4-0200	EQUIPMENT- OFFICE	5,000.00	59.99	3,583.48	1,416.52	72%

	CLASS TOTAL	5,000.00	59.99	3,583.48	1,416.52	72%

APS6070
7/01/21
8:52:13

BUFFALO
CURRENT EXPENDITURES FOR JUNE 30, 2021
(0100) COUNTY GENERAL

		Budget Adopted	Expenditures	Year-to-date Expenditures	Budget Remaining	Percent Used

5-0500	OFFICE EQUIPMENT	.00	.00	.00	.00	0%

	CLASS TOTAL	.00	.00	.00	.00	0%

645-00	COOPERATIVE EXTENSION	148,633.60	10,419.31	102,768.81	45,864.79	69%

BUFFALO
Adopted Budget Listing
(0100) COUNTY GENERAL
FROM 00100-000 TO 09999-999

Estimated Expense Ensuing Year 2021-2022

Actual Expense 2019-2020 (1)	Actual Expense 2020-2021 (2)	Official Estimation (3)	Board Proposed (4)	Adopted (5)
---------------------------------------	---------------------------------------	-------------------------------	--------------------------	----------------

645-00	COOPERATIVE EXTENSION				
	PERSONAL SERVICES				
1-0100	OFFICIAL'S SALARY	.00	.00	.00	.00
1-0200	DEPUTY'S SALARY	.00	.00	.00	.00
1-0301	EXTENSION ASSISTANT	19,999.25	4,350.75	20,000.00	20,000.00
1-0305	CLERICAL SALARY	66,146.97	68,120.64	75,019.20	75,019.20
1-0405	CLERICAL P/T SALARY	.00	.00	.00	.00
1-0408	PART-TIME SALARY JANITOR	.00	.00	.00	.00
1-0423	AG AGT - AIDES P/T SAL	16,286.70	7,007.00	13,784.00	13,784.00
1-0500	OVERTIME	1,319.60	1,158.85	3,500.00	3,500.00
1-0801	WORKMANS COMPENSATION	.00	.00	.00	.00
1-0802	HEALTH INSURANCE	.00	.00	.00	.00
1-0803	LIFE (FORT DEARBORN)	.00	.00	.00	.00
1-0804	LIFE INSURANCE	.00	.00	.00	.00
1-0900	RETIREMENT	5,250.04	4,676.33	5,994.22	5,994.22
1-1000	OASI	6,175.20	5,590.73	6,793.44	6,793.44
	PERSONAL SERVICES TOTAL	115,177.76	90,904.30	125,090.86	125,090.86
	OPERATING EXPENSES				
2-0100	POSTAL SERVICES	3,236.88	922.29	2,500.00	2,500.00
2-0200	TELEPHONE SERVICE	1,200.00	1,200.00	1,200.00	1,200.00
2-0900	GEN FINANCE/ADMIN EXPENSE	.00	.00	.00	.00
2-1200	OFFICE EQUIPMENT REPAIR	.00	.00	.00	.00
2-1601	CAR REPAIRS	1,089.58	190.44	500.00	500.00
2-1704	MILEAGE	2,658.68	290.00	4,000.00	4,000.00
2-1708	BOARD MEMBERS EXPENSE	100.00	116.74	250.00	250.00
2-1801	DUES, SUBSCRIPTIONS & REG.	78.56	515.96	350.00	350.00
2-2515	CONTRACTUAL SERVICES	.00	.00	.00	.00
2-9900	MISCELLANEOUS	.00	219.93	500.00	500.00
	OPERATING EXPENSES TOTAL	8,363.70	3,455.36	9,300.00	9,300.00
	SUPPLIES AND MATERIALS				
3-0100	RENTAL EXPENSES	.00	.00	.00	.00
3-0101	OFFICE SUPPLIES	3,300.37	2,825.55	3,500.00	3,500.00
3-0124	PROGRAM SUPPLIES	3,313.35	2,000.12	3,500.00	3,500.00
	SUPPLIES AND MATERIALS TOTAL	6,613.72	4,825.67	7,000.00	7,000.00
	EQUIPMENT RENTAL				
4-0200	EQUIPMENT- OFFICE	6,859.04	3,583.48	5,000.00	5,000.00
	EQUIPMENT RENTAL TOTAL	6,859.04	3,583.48	5,000.00	5,000.00
	CAPITAL OUTLAY				
5-0500	OFFICE EQUIPMENT	.00	.00	.00	.00
	CAPITAL OUTLAY TOTAL	.00	.00	.00	.00
	TOTAL EXPENDITURES	137,014.22	102,768.81	146,390.86	146,390.86

Is this fund designated as a Special Reserve Fund?
If Yes, What is the particular purpose for setting funds aside? _____

To the County Board:
Request is hereby made for the adoption of the estimated budget expenses for the fiscal year concerning July 1, 2021,
and ending June 30, 2022, as indicated in Column (5).

Dated _____ COOPERATIVE EXTENSION _____
Office, Activity or Function Signature of Officer

2021 Impact At-A-Glance

Brought to you by Nebraska Extension

buffalo.unl.edu

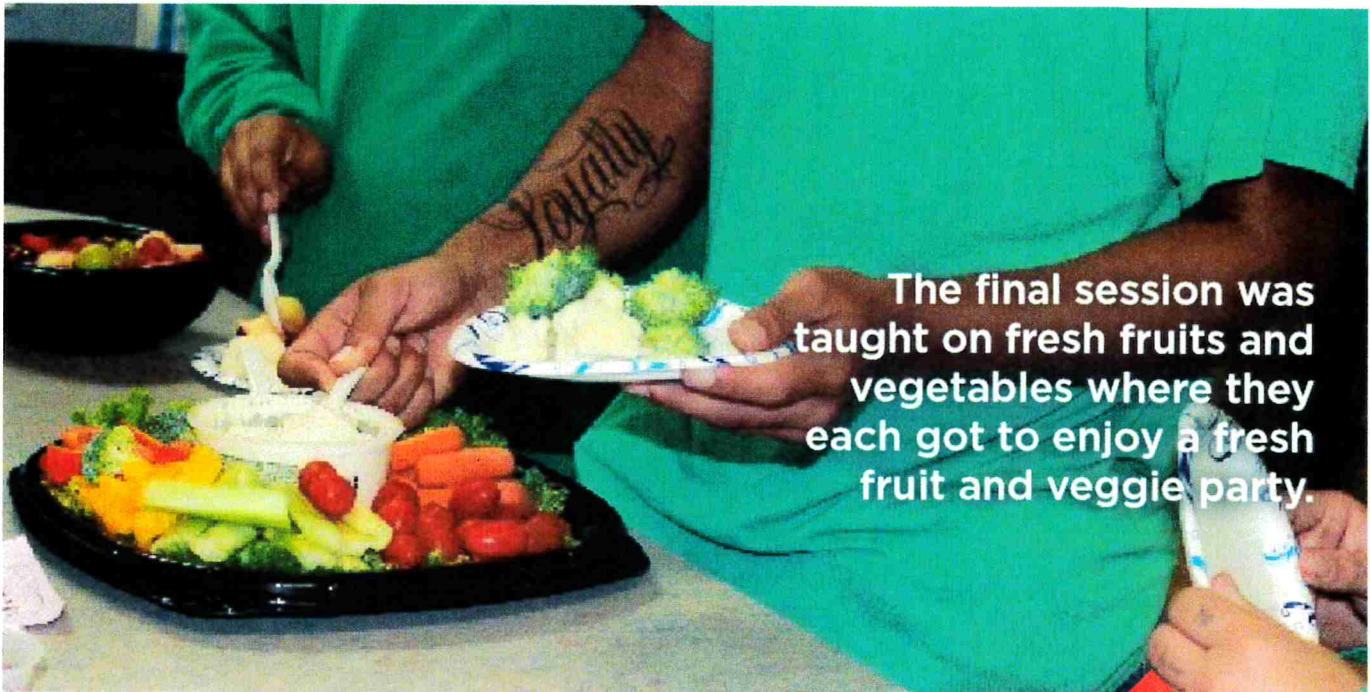

The final session was taught on fresh fruits and vegetables where they each got to enjoy a fresh fruit and veggie party.

The Youth Rehabilitation and Treatment Center (YRTC) partnered with NEP and Nebraska Total Care to implement the Marathon Kids program. YRTC students ran a total of 1,094 miles with an average of 2 marathons per student. Staff reported fewer behavior issues with students while engaged in this program. "Running makes me clear my head, and then I can go back and make better decisions."

Programs At-A-Glance

- 26 youth explored entrepreneurship concepts by developing and selling products at the farmers' market through a school enrichment program.
- Twenty childcare providers took Pyramid Model for Social-Emotional Learning 6-hour Mindfulness training.

429 4th-grade students learned about engineering and problem solving skills through school enrichment.

26 youth learned about raising and showing animals during the Lamb and Goat camp. 12 showed their lambs and goats at the county fair.

6 On-Farm Research studies completed with growers and crop consultants.

Kerry Elsen – Summary Statement

2021 came with its own set of challenges. Many of those are related to the pandemic and beginning the recovery process. We were forced to be more flexible in every way and did all we could to meet clientele where they were at. School enrichment was all done virtually. Our school systems were great to work with as it took more involvement from the classroom educator than in previous years. I worked with individual classrooms as 1 group, as well as multiple classes with individual iPads. I have a new perspective on classroom management. Beginning in the fall of 2021, all of Kearney Public Schools is completing the full Ag literacy program and is back to allowing in-class education.

Aside from the programmatic flexibility I am developing a feeling of ease as I continue to fully understand the role of Lead Educator. I have gone from supervising a 4-H assistant to now supervising 4 individuals. The working relationship between Extension and our County Officials continues to improve and Extension Board is becoming a higher functioning board.

Wellness In Tough Times

Gibbon was a community impacted by flooding and was selected to receive funds to improve mental wellness within the community. I worked with the community representative to select round picnic tables to be installed in their park next to the swimming pool to promote conversation among those utilizing the park or pool. In addition, the community received a little library providing 24/7 access to 22 children's books on resiliency. In addition, an entire set was also added to their public library. After sharing information with the Australasia-Pacific Extension Network (APEN) in October of 2020, the Rural Recovery Support Team (RRST) in Northern NSW and Tablelands in Australia learned what Wellness in Tough Times was doing and reached out to us to learn more. As a result, the RRST initiated a program called Tailgate4Mates modeled after Neighbor-to-Neighbor. *"The Tailgates4Mates has been an outstanding success. It has been particularly good for engaging with our male clients and has provided a great opportunity for us to introduce mental health clinicians to the community in a social and non-threatening environment...Thank you for the inspiration provided by your team."* - Greg Mills, Rural Recovery Support Services, Australia

The youth subcommittee has become **Navigating Wellness: Creating Resilient Youth**. This committee provided articles that are found on the "Supporting Young People Website." Articles are useable for print and have been shared on Twitter and Facebook. The Supporting Young People website saw 984 pageviews, Twitter reached 1,187 and Facebook reached 4,834 users. The committee is participating in the Impact Collaborative Summit to determine the scope and capacity of programming the team will develop.

Tri-City Huddle

Through timely and relevant efforts of the Tri-City 4-H Huddle Team (Buffalo, Adams, Hall 4-H staff), 2,907 youth /adults were reached in 2021. The team received three state awards and their curriculum and efforts shared on a local, regional, and national stage. My role: teacher and curriculum development. The **Stop the Pass** curriculum was presented nationally at the STEM Symposium, NAE4HYDP conference (n=63), and local/regional efforts reached 507 youth from 12 schools. Comment: "Thanks for the great demonstration and access to the curriculum!" Teacher comment: "Loved the door hangers!" "Fun and engaging - just what the kids needed!" Impact: 100% of students increased their understanding of how illness/diseases spread and 100% of teachers stated the lesson was beneficial for their students. Additionally, the Tri-City Huddle's **Sparks2Share Newsletter** shared youth development resources and activities with 812 teachers monthly in the Tri-City area and viewed from locations all over the nation. My role: newsletter content and local distribution. Through a national NAE4HYDP poster session, over 1,525 youth development professionals were reached. Impacts: 1 in 3 teachers/survey respondents said they have utilized activities in the newsletter. A teacher commented: "It is beautifully designed and has some great information. I particularly like the quick items to do with

your students. Thanks for the work you put in." A principal stated: "The Kearney Public Schools system has appreciated the partnership and innovation of the Tri-City team!"

Animals Inside & Out

The team reached 1577 youth at 13 sites. *My Contribution:* taught the By-Products sessions in Minden and Holdrege for a total of 196 youth. **Include your own Impact Here.** *Impact:* Participants who completed the post-program evaluation reported:

- 91% thought Animal Science was cool
- 96% learned something new
- 95% know that farmers make good choices to keep our food safe; and
- 88% reported that they better understood where their food comes from.

One Teacher reported: "Our third-grade classes take part annually in an excellent program called Animals Inside & Out through our local Nebraska Extension Office. It features actual hands-on learning within small group sessions. This captivating program allows my students insight we could never experience in the classroom. As a result, they were very interested in learning more about the many careers associated with the animal industry. Overall, this program also gives students a strong foundation for further study of our own body systems." Kim Steen, Minden 3rd Grade Teacher

Youth Science Field Days

Based upon teacher feedback, **in-person YSFDs** were held in Holdrege and Hastings reaching 227 youth in October. *My contribution:* I facilitated the "What is Science" virtual session in Hastings as well as co-taught "Stop the Pass" in Hastings and Holdrege. *Impact:* Evaluation from the program showed youth stated "Strongly Agree" or "Agree" to the following statements:

- 81% "I am able to connect what we learned here today to the science we learn in school."
- 83% "I was introduced to science in a new way today."
- 59% "I think about science and its impact on my life differently after today's experience."
- 92% "I think learning new things about science, engineering, and technology is fun."

Serious About Science

Buffalo County has created simple, short, and effective science concept videos. Viewers can recreate experiments at home using common supplies. Videos introduce audiences to a challenge and then through trial, explains what is or is not happening. Videos are posted to our 4-H Facebook page. Twelve episodes have been posted with an average of 215 views per episode.

Key Extension Excellence Practices

The key practices I am focusing on for 2022 are impact and meaningful. I strive to develop highly impactful and meaningful programming where participants are able to walk-away with an improvement in their lives.

What's on the horizon

2022 will provide additional opportunities to enhance current programming with more impactful and meaningful education. School systems are constantly looking for ways we can provide supplemental education for their students. Efforts are continually being made to enhance current programs. With the addition of a 4-H assistant, we can find opportunities to provide more field day style opportunities for area students. I intend to focus on STEM through agriculture literacy programming during in-class school enrichment, BRAG, and Youth Science Field Days. Additionally, Serious About Science and efforts from the Tri-City Huddle team will continue. Buffalo County will also work diligently to create educational opportunities for students who are not currently being reached.

ANNUAL REPORT OF FACULTY ACCOMPLISHMENTS
Institute of Agriculture and Natural Resources and College of Education and Human Sciences
University of Nebraska-Lincoln

NAME: Brent Plugge

UNIT(s): West Central Research & Extension Center

COURTESY APPOINTMENT(s): NONE

TENURE STATUS:

GRADUATE FACULTY:

APPORTIONMENT INFORMATION:

Extension: 97%

Service: 3%

REPORT PERIOD: January 1, 2021 - December 31, 2021

2021 YEARLY SUMMARY STATEMENT

2021 Summary Statement

Delivered programmatic information to those in the stocker/yearling segment, improving knowledge and financial gain. A four-part webinar series and an in-person program and tour highlighted the delivery methods.

Hosted a successful Nebraska Grazing Conference, reaching 140 grazing enthusiasts. Management changes and significant financial gain are expected as a result of attending the conference.

Utilized the Mobile Beef Lab to teach science related concepts, Presented at two virtual field days, one in-person field day and three Animals Inside and Out programs. A total of 363 students were impacted.

In partnership with Nebraska Cattleman, hosted Cattleman's College. Forty producers attended the college with many reporting positive information that is likely to impact their operation.

Developed a interactive display for teaching BCS at Husker Harvest Days reaching 182 unique visitors.

Co-Authored four System Budgets for Cow Herds.

Hosted two BQA Trainings, attended by 6 producers.

Member of the Nebraska Integrated Beef Systems Hub Faculty Advisory Committee.

Co-developed a framework and protocol for the acquisition of a land gift to IANR.

Participated in Nebraska's Largest Outdoor Classroom day reaching 901 clientele with the Mobile Beef Lab.

In a secondary role, hosted Private Pesticide Trainings, Chemigation Certification, a Land Manager Meeting and the NGLC Traveling Road Show.

Participated in "Systems Thinking" Workshop, Nebraska Cattleman's Annual Convention and Range Beef Cow Symposium for Professional Development.

Member of Webster County Beef Educator Search Committee.

Became a BQA Certified Trainer.

Purchased and read Inclusive Leadership with the personal goal of improving inclusiveness in the workplace. I focus on inclusion in every interaction and in every team setting. The results have been greater solutions to potential challenges and that becomes even more apparent in more inter-disciplinary settings.

It is the policy of the University of Nebraska-Lincoln not to discriminate based upon age, race, ethnicity, color, national origin, gender, sex, pregnancy, disability, sexual orientation, genetic information, veteran's status, marital status, religion or political affiliation.

ANNUAL REPORT OF FACULTY ACCOMPLISHMENTS

*Institute of Agriculture and Natural Resources and College of Education and Human Sciences
University of Nebraska-Lincoln*

NAME: Ranae Aspen

UNIT(s): West Central Research & Extension Center

COURTESY APPOINTMENT(s): NONE

TENURE STATUS:

GRADUATE FACULTY:

APPORTIONMENT INFORMATION:

REPORT PERIOD: January 1, 2021 - December 31, 2021

2021 YEARLY SUMMARY STATEMENT

I am in my 15th year of providing the SNAP-ED program in Buffalo County. Emerging issues in our county are examined by networking with professionals who provide Human Services. Issues of food insecurity & healthy food choices are an issue present in our community. I provide a viable service in our community complimenting the work of the partnering agencies I serve.

The goals for the NEP program are to 1. Prevent & reduce the level of obesity & chronic disease in low-income Nebraskans throughout the life cycle with the use of evidence-based multi-level interventions/public health approaches that reach low-income households most impacted by health disparities & 2. Increase the likelihood that people eligible for SNAP will make healthy food choices and choose physically active lifestyles more often.

SNAP-ED in Buffalo County taught 7 groups, 11 sessions, & 11 hours of teaching. 2021 continued to present challenges as COVID was still an issue. Programming was completed virtually. I taught 144 youth from ages 5-18. 70% were white, 15% were Hispanic, 12% were black, 3% were American Indian. 6 programs used the Marathon Kids curriculum, supplemented with the CATCH Kids Club curriculum, & one program used Kids in the Kitchen for the curriculum.

A collaboration was formed with Nebraska Total Care, one of the Medicaid options for residents of Nebraska. This partnership allowed Buffalo County SNAP-ED to reach out to new & established low-income audiences & make an impact during the challenges with COVID.

While schools were unable to have direct face-to-face programming in the school setting, Marathon Kids provided a way to encourage physical activity. Several students commented that while they are not fond of exercise, they did enjoy marathon kids. The surveys told the story that they were engaged in logging minutes of physical activity. The added incentives that Nebraska Total Care was able to enrich the programs with was of help in motivating students to log more miles.

Kearney Community Learning Center (KCLC), the local 21st Century Learning Center embraced the Marathon Kids program. 91 students actively participated in the Marathon Kids Summer Camp. Students logged a total of 5,039 miles. Students reported that they enjoyed the activities, liked tracking their miles, enjoyed the prizes, & one student reported that they believe in themselves because of participating in Marathon Kids. The director of KCLC was impressed with the outcomes. KCLC saw improvements in behaviors with students. Moving forward, the director plans to write a grant for running clubs that will include each student receiving running shoes. We hope to implement this in the fall of 2022.

A new partner this year was with the Youth Rehabilitation & Treatment Center (YRTC). This is the first Nebraska Extension program with this agency. The facility houses court-ordered male juvenile offenders. Their mission is to help youth live better lives through effective services, giving youth the chance to become law-abiding citizens.

YRTC partnered with NEP & Nebraska Total Care to implement the Marathon Kids program. YRTC students ran a total of 1,094 miles with an average of 2 marathons per student. Staff reported fewer behavior issues with students while engaged in this program. "Running makes me clear my head, and then I can go back and make better decisions." The students all received Marathon Kids T-shirts for participating & running at least one marathon. Nebraska Total Care provided each student with sweatbands & a booklet, "Road to Good Living" Nebraska Total Care presented material for transitioning youth to independent living & the health services that are available to them.

2021 allowed for professional development opportunities along with the programming that was impactful. My professional focus was on Diversity, Inclusion, Equity, & Belonging.

I completed training in the Lakota Medicine Wheel Talking Circle. I lead a Lakota Medicine Wheel Talking Circle training in December that will be completed in January of 2022. The initial training & the group that I took & that I led have been rewarding. I have increased my awareness of my self-identity with the training from the Lakota Medicine Wheel, and this has assisted me in increasing my IDI (Intercultural Development Assessment). The pre-survey indicated a 16.9 gap between my perceived orientation & my Developmental Orientation. The goal is to reduce the gap between the perceived & the developed orientation. When I took the post-survey, the gap is now reduced to 3 points between perceived & developed orientation.

Diversity, inclusion, equity, & belonging are continuous works in progress. I am passionate about this & will continue to work on this very important area of cultural awareness. I see this as a developmental opportunity to continue to build on my knowledge of cultural differences & to further develop skills for adapting to these differences. It is beneficial to develop cultural mediation & advocacy strategies to assist others more effectively in my community & in Nebraska Extension who do not have the experience and skills to bridge cultural differences on their own. My ongoing goal is to further my acceptance, understanding, & mindset to incorporate adaptive strategies when interacting across cultural diversity. Moving forward, I hope to continue collaborating with Nebraska Total Care to reach more low-income families in our community. I will work on program planning for face-to-face direct education but will also have backup plans for virtual delivery of SNAP-ED programming. This combined with continuing to take advantage of professional development opportunities will allow the SNAP-ED program in Buffalo County to improve and increase its outreach and impact on low-income families in our community.

2021 CV or Resume

[Ranae Aspen 2021 Vitae-1.pdf](#)

EXTENSION ACCOMPLISHMENTS

2021 Goal(s):

Prevent and reduce the level of obesity and chronic disease in low-income Nebraskans throughout the life cycle with the use of evidence-based multi-level interventions/public health approaches that reach low-income households most impacted by health disparities.

-Continue to reach out to establish partnerships to offer remote programming and face-to-face programming when safe to do so.

-Work with new partners with current programs to promote healthy lifestyles using programs such as Marathon Kids and Kids in the Kitchen along with other approved evidence-based curriculum. Comprehensive Health & Well-being

Increase the likelihood that people eligible for SNAP will make healthy food choices and choose physically active lifestyles more often.

-Continue to partner with schools to provide youth programming.

-Continue to network with agencies who work with low-income families to let them know about the programs available to their clientele.

Comprehensive Health & Well-being

Broader Impacts of Extension (Optional): Prevent and reduce the level of obesity and chronic disease in low-income Nebraskans throughout the life cycle with the use of evidence-based multi-level interventions/public health approaches that reach low-income households most impacted by health disparities. Continue to reach out to established partnerships to offer remote programming and face-to-face programming when safe to do so. Work with new partners with current programs to promote healthy lifestyles using programs such as Marathon Kids and Kids in the Kitchen along with other approved evidence based curriculum.

CREATING AN INCLUSIVE ENVIRONMENT

Activities and Accomplishments: -I completed training in the Lakota Medicine Wheel Talking Circle.

-I lead a Lakota Medicine Wheel Talking Circle training in December that will be completed in January of 2022.

-I have increased my IDI (Intercultural Development Assessment). The pre-survey indicated a 16.9 gap between my perceived orientation & my Developmental Orientation. The gap is now reduced to 3 points between perceived & developed orientation.

Diversity, inclusion, equity, & belonging are continuous works in progress. I see this as a developmental opportunity to continue to build on my knowledge of cultural differences & to further develop skills for adapting to these differences. It is beneficial to develop cultural mediation & advocacy strategies to assist others more effectively in my community & in Nebraska Extension who do not have the experience and skills to bridge cultural differences on their own. My ongoing goal is to further my acceptance, understanding, & mindset to incorporate adaptive strategies when interacting across cultural diversity.

Goals: -I will lead more Lakota Medicine Wheel Talking Circle as requested.

-I will provide training to my community with regard to inclusion as requested.

These contributions correspond to: Extension/Engagement/Outreach, Teaching and Learning

2021 Summary Statement
Elizabeth Exstrom
Community Environment Extension Educator

2021 Story

This past year provided some different opportunities for programming. My main goal continued to be to meet the needs of the clientele in a way that gave them the best opportunity for education and for the greatest potential for long-term impacts. I utilized my position description to help plan my goals and objectives and I set action steps that would help me to achieve them. The action steps changed throughout the year depending on what I needed to do to meet my goals and objectives. Contact with clients and programs still had to be adjusted on the fly depending on regulations at the time. I had to pivot my method of delivery from doing face-to-face programming to online or zoom trainings and in some cases the program was not able to be delivered at all. I also took time off this year to focus on our family while I spent time on maternity leave with our twins. While it wasn't a 'normal' year in any sense of the word, I was still able to offer the same great programs and answer client questions in a way that made them feel comfortable and still offer the quality education they come to expect.

Most Impactful Work and Significant Contributions

In 2021, the Community Environment Water Working group implemented a new program called *Water Dogs*, which is an Extension Master Gardener (EMG) driven, landscape water and soil conservation program. Its aim was to increase EMGs understanding of turfgrass water needs, efficient irrigation methods, and soil health management to conserve water, reduce runoff from properties, and improve turfgrass rooting. The group secured a \$3,000 Public Information and Education (PIE) grant through Nebraska Academy of Sciences and Nebraska Environmental Trust.

I was one of six UNL Extension Educators and two Extension Specialists that worked with the program. Four peer reviewed fact sheets were written, reviewed, and printed. Each Educator found volunteers in their county(ies) to participate in the program; I had one in Hall and one in Buffalo County. At each EMG's home, we conducted an audit of their irrigation system which tested sprinkler head efficiency and looked for flaws in the in-ground irrigation system like broken or mis-directed sprinkler heads (an average audit takes about 5 hours). We also sampled turf soil and had it tested, measuring soil compaction with penetrometers, and demonstrated to volunteers how to use a moisture meter and screwdriver to estimate soil moisture. Throughout the growing season (May-October), volunteers recorded soil moisture/screwdriver findings and noted when they irrigated.

In 2022, trained EMGs will conduct the program by completing the irrigation audits and educating clientele about the topics covered in the *Water Dogs* program.

The Extension working group hired the Bureau of Sociological Research (BOSR) at UNL to administer a post-program evaluation of participants and compiled the data from the evaluation. Volunteers recorded their previous irrigation and turf management techniques as well as what they learned throughout the course of the *Water Dogs* program. Key findings include:

- 91% reduced water use through participation
- 75% improved irrigation efficiency
- 73% increased knowledge of the importance of basing irrigation on soil moisture levels and plant needs a lot
- 71% increased knowledge of the consequences caused by incorrect manual/automatic irrigation on water waste and soil health a lot
- 69% saw a big difference between irrigation frequency based on soil moisture vs. a preset timer
- 67% had better turfgrass
- 61% based irrigation frequency on soil moisture meter very closely
- 59% followed turning the system off and only using when meter indicated very closely

EMGs who now feel very to extremely competent at specific practices learned from the Water Dogs Program:

- 83% at operating the irrigation system manually
- 82% at describing what soil compaction is
- 81% at explaining different techniques to mitigate compaction
- 81% at using a soil moisture meter
- 56% at determining when and how much water to apply for landscape irrigation based on soil moisture levels and plant needs

Planned behavior changes of EMGs who had not already been following such practices were:

- 83% plan to turn off irrigation system until soil moisture meter indicates a need
- 61% plan to water based on turfgrass species needs

The *GROBigRed Virtual Learning series* engaged 1742 learners from Nebraska and across the country in about vegetable gardening, houseplants, pollinators, pests, and more. I taught 3 programs and moderated/facilitated 7. In a post-program survey (n=175), attendees ranked their average knowledge gain as 7.9 on a scale of 10. Overall, 76.2% of attendees surveyed indicated that they had adopted one or more practices they learned from the sessions and 74.7% indicated that they are planning to implement new knowledge in the future. Nearly 78% of surveyed attendees also indicated that they had shared information they learned from the series with someone else.

Central Nebraska *Extension Master Gardener* (EMG) Program offered 60 hours of education to 87 EMGs from 10 counties who contacted 1,461 clients & volunteered 1,760 hours locally; public value \$46,464. EMG volunteers assisted with donation gardens that provided over 6,800 pounds of produce to families in need.

The *Nebraska Extension Special Garden Project* distributed 1,520 packets of Hakuri Turnips to 87 counties across Nebraska (94% of Nebraska Counties). Project taught youth how to successfully grow a new cultivar & implement new sustainable gardening techniques. Practices youth plan to improve for next season include weed control, plant earlier, amend the soil & watering properly.

I contacted 5,720 *clients and program participants* through 95 hours of programming viewed in several states including Arkansas, Tennessee, Oklahoma, Iowa, Michigan, and Kansas. West Virginia Extension reached out to me about how to administer an online Horticulture Judging contest. Mentored the new Horticulture Aide in Buffalo County and offered support for the Adams County Horticulture Aide. Joined Backyard Farmer twice and Digging Deeper once during the growing season to an audience of over 130,000 across multiple platforms. Brought in \$8,540 from program fees.

Key Extension Excellence Practices

Some of the Key Extension Excellence practice that I am focusing on improving in the coming year include relevance and diversity, equity and inclusion. In order for our programs and education to compete with other non-science based information (aka Google), we need to make sure that our programs remain relevant to clientele. Whether that is advertising in a different way or programming using a different platform, we need to remain relatable to clientele. I am also pursuing how to offer my programs to more diverse populations and to be more intentionally inclusive with my programming.

Looking Ahead

My aspiration is to meet the needs of the clientele in a way that give them the best opportunity for education and for the greatest potential for long-term impacts. My goals, objectives, and action steps will help guide my progress. As we have found the past few years, it is an evolving process that can change, so remaining nimble and responsive to clientele needs will be key.

ANNUAL REPORT OF FACULTY ACCOMPLISHMENTS

*Institute of Agriculture and Natural Resources and College of Education and Human Sciences
University of Nebraska-Lincoln*

NAME: Sarah Sivits

UNIT(s): West Central Research & Extension Center

COURTESY APPOINTMENT(s): NONE

TENURE STATUS:

GRADUATE FACULTY:

APPORTIONMENT INFORMATION:

Extension: 97%

Service: 3%

REPORT PERIOD: January 1, 2021 - December 31, 2021

2021 YEARLY SUMMARY STATEMENT

This past year emphasized leadership, growth, and research. I became a co-Lead Educator in April 2021 where duties included managing office budgets, staff, vehicles, and inventory while engaging Extension Boards and county commissioners. My husband and I welcomed our first child and I was on maternity leave from August—November. Through these experiences, I have grown and learned that I need to grant myself grace as I'm adjusting to a new work-life balance. While programming efforts were reduced due to the pandemic and maternity leave, I sought to deliver high-quality programs on integrated pest management (IPM) strategies and on-farm research.

Goal (1): Educational programming will encourage Nebraskans to identify and manage harmful pests.

Pesticide Resistance Management: Taught producers during 22 pesticide applicator and chemigation trainings (n=286) about pesticide safety, laws/regulations, application technology, IPM strategies, and resistance management. Participant numbers were down in 2021 due to the pandemic and trainings were altered to avoid small group work to ensure participants were safe. Meetings were successful as cited by participant comments: "You're doing a great job up there. Keep things moving, very knowledgeable on the material. I'm very impressed."; "One of the most thorough presentations I've been to. Nice job."; "Much better than in the past. Actually paid attention and learned this time."

Agronomy Youth Field Day: Youth (n=23) participated in the 5th Annual Agronomy Youth Field Day in Curtis. This program was a team effort among 4-H and Crops Educators/Specialists. Topics included drone technology, precision ag equipment, soil health, and disease identification. Survey results indicated that 86% of participants rated the overall program as excellent. I taught the disease identification session where youth learned basic microscopy and slide making techniques to observe fungal spores. Pre-/post-test assessments demonstrated a 53% increase in knowledge about disease identification and basic microscopy by participating in this session. Participant comment: "This was my favorite session by far today!"

State Fair ID Prep: Hosted 11 in-person practices for the 4-H Identification Contest. Youth (n=11) ranging from 8-17 years of age participated in practices from April to August. Mike Wolff, 4-H Assistant, and I held practices that included visits to the lake, pasture walks, and examining live specimens. Pre-/post-test assessments demonstrated a 78% increase in knowledge about weeds, grass, trees, horticulture, and insects by participating in these practices. At the State Fair Identification Contest, youth (n=4) competed in the Grass & Weeds, Horticulture, Tree, and Insect identification contests. Results from the 2021 Nebraska State Fair are as follows: Weeds & Grass ID Senior Division—2nd, 4th, 5th, and 6th place individual awards; 1st place team award. Horticulture ID Senior Division—9th place individual; 3rd place team. Insect ID Senior Division—4th place individual. Tree ID Intermediate Division—5th place individual. Comment from 4-H parent: "Thank you for all you have done with the 2021 Fair and coaching for the ID contests. My kids really enjoyed themselves and have learned so much!"

Intellectual Contributions: Co-authored and edited the disease section for the 2021 Guide for Weed, Disease, and Insect Management in Nebraska (EC130—10,000 physical copies sold; at \$25/book the total value is \$250,000). Co-authored one CropWatch article on "Which 2,4-D Product Should I Use as a Burndown Before Planting Enlist E3 Soybean?" (2,352 page views). Wrote 28 articles pertaining to crops, pest management concerns, and water related issues for the local newspapers in my accountability region (3 counties, 7 newspapers, circulation 102,035 families). Two interviews with NTV News on planting conditions and crop disease concerns. Developed one N'Field Observation video about a corn disease (Holcus Spot) that was

My top strengths as identified by the Gallop Strengths poll are Developer, Harmony, Includer, Connectedness, and Positivity. **Many of the programs I teach are held in a series of 8 weeks or more. The group sizes are kept to around 12 participants to ensure a safe and trusted learning environment where I help to build a community of care among my participants.**

In 2021, I taught 574 in-service hours to 4627 childcare providers across 50 workshops and coaching sessions both locally and statewide, emphasizing mindfulness and self-care saving teachers \$68,225 in fees and materials.

Cultivating Healthy, Intentional, Mindful Educators (CHIME 8- week series) Is one of my signature programs related to my strengths. During April 2021-December 31, our team had 67 early childhood professionals participate in the CHIME program in Nebraska. Most participants identified as female (97%), 78% are white, 2% are black or African American, 2% are Native American or Alaska Native, and 4% are of mixed race. These teachers represent a wide array of early childhood centers across Eastern Nebraska, including Head Start, school-affiliated centers, private centers, and family home childcare. **I personally taught 17 childcare professionals in two separate 8-week sessions, from 13 childcare sites.**

These participants were able to participate in CHIME due to receiving a sub-award for the Preschool Development Grant; Hatton-Bowers, H. (PI) (April 2021-April 2022). Mindfulness in Early Care and Education. Federal Preschool Development Grant Birth through Five. US Department of Education. (subaward, \$151,315)

Summarized Feedback After Completing CHIME:

98% agreed they would recommend CHIME to other early childhood teachers. 98% agreed they liked the activities used in the CHIME sessions, 97% agreed they like the materials used in the CHIME sessions, 98% agreed that participating in the CHIME program was a good way to support their emotional well-being, and 98% agreed that overall CHIME was beneficial for their work as an early childhood educator. 100% agreed that they made positive changes to their daily routine or classroom as a result of participating in the CHIME program and 99% agreed they would use mindfulness practices in their personal life.

Behavior Changes:

Participants increased their mindfulness and mental well-being and significantly decreased their perceived emotion dysregulation from before to after participating in the 8-week CHIME program.

Quote from my participant:

"Mindfulness has helped me feel more present, aware and in control of my emotions and stress. I am finding that I don't have to let the stress, frustration or overwhelming feelings take over me. I can feel them, breathe through them, and do my best. I am going to continue practicing the breathing, compassion, and gratitude activities with the children in my center. I am also going to try to meditate at least once a week for myself & hopefully build to more often. I don't have much time to myself but am realizing now important selfcare is! Thanks!"

To further disseminate CHIME, our team held a Guiding Teacher Training for 8 collaborators from Nebraska and Nationally from, Minnesota, Washington State, Colorado, New Mexico, Oregon, and internationally from Brazil. Our team has continued to meet with these trainers monthly serving in a mentor role to ensure program fidelity.

Pyramid Mindfulness Training, Summarized Feedback from our team:

There were 95 total participants, all of whom identified as female and 92% as White/Caucasian, 8% Hispanic/Latino, that completed the survey to provide feedback on the training. Approximately 33% were center-base providers, 21% were family-home providers, 18% were center directors and 28% had other roles such as coach or mental health specialists. **I personally taught 4 sessions to 43 participants from the Six Pence and Rooted in Relationships Cohorts from Saline, Hall and Buffalo Counties. Each County enrolled in 12 hours of Pyramid Year 3.**

How confident are you (completed by 57 participants)

At the beginning of the training, 41% of participants indicated they were confident using mindfulness practices to support young children. At the end of the training, 80% of participants indicated they were confident. In other words, there was a 39% increase in participant’s confidence to use mindfulness practices to support young children. At the beginning of the training, 40% of participants indicated they were confident aligning mindfulness practices with the Pyramid model. At the end of the training, 90% of participants indicated they were confident aligning mindfulness practices with the Pyramid model. In other words, there was a 50% increase in participant’s confidence to use mindfulness practices to support young children.

How frequently (completed by 57 participants)

At the beginning of the training, 47% of participants indicated that they often calmly tell children how they are feeling when they are upset with children at work. After the training, 63% participants indicated they often calmly talked to children when upset at work. This is a 16% increase. At the beginning of the training, 65% of participants indicated they often are aware of how their mood affects the way they treat children. After the training, 90% indicated they are often aware of how their mood affects the way they treat children. This is 25% increase.

Recommend to others: Approximately 87% of participants indicated they would recommend this training to other early childhood professionals.

Quote from one of my participants: What were your key takeaways from this training?

“I realize how much a calm delayed response is very beneficial to myself, my staff and the children in our care. I have always known this, but the tools presented here help me to try to practice mindfulness in my work. I would like my staff to take the class also. I feel if we all work with the children in our daily practices, helping one another each and every day is very beneficial to everyone.”

On-line professional development, statewide

I taught 102 hours of additional programs state-wide by joining with Early Childhood team members to teach Mindful Self-care for Childcare Professionals, Read for Resilience, Block Party, Summer Reading Program, Fun at the Fair, Children Thrive Outside, and the Family Engagement 3-part series to name a few.

Follow up data from online classes – 2020 and 2021 (sent 3 – 9 months following class participation)

	1 – 2 classes	3 – 6 classes	7 or more classes
N= number of people emailed	N= 1379	N= 369	N=92
n= number of completed responses	n= 447	n=163	n=52
Participants reporting they have implemented a great deal or a lot of what they learned in classes in their work	75%	85%	98%
Overall rating of the class on scale from 1 - 5	4.66	4.74	4.88

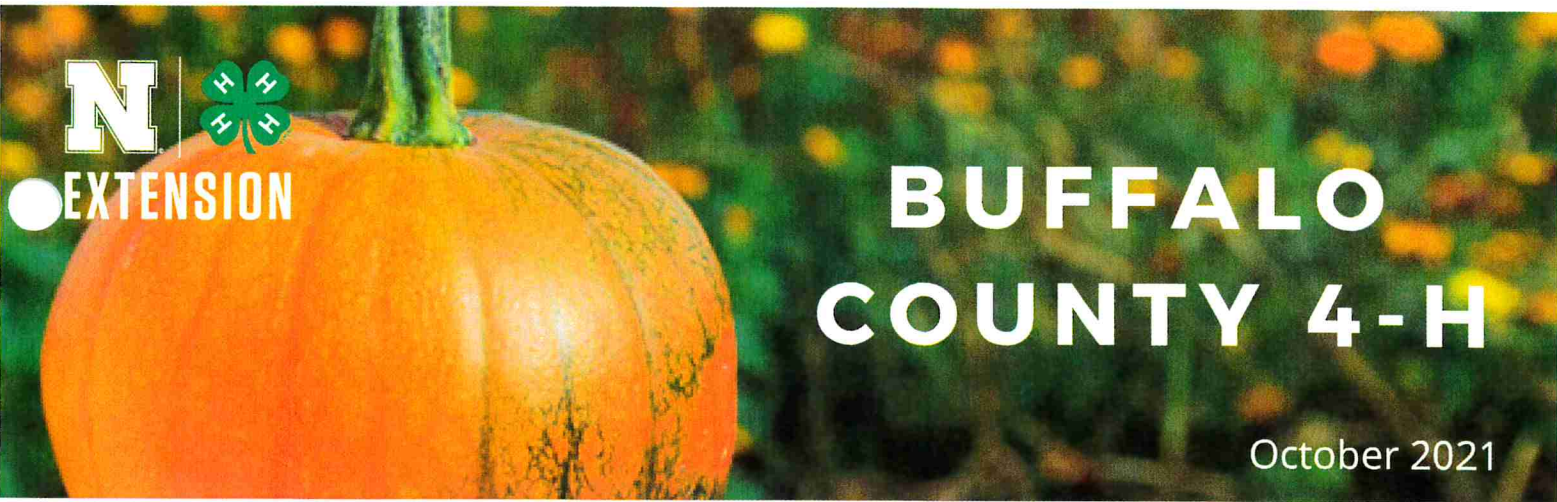

BUFFALO COUNTY 4-H

October 2021

Nebraska Extension-Buffalo County 1400 E. 34th St. Kearney, NE 68847 (308)-236-1235 buffalo.unl.edu

CELEBRATE NATIONAL 4-H WEEK

OCTOBER 3-9, 2021



CALENDAR

- October 1 - Diamond Clover applications due
- October 1 - Achievement applications due
- October 1 - Club of Excellence applications due
- October 11 - Columbus Day - Extension office closed
- October 26 - 4-H Council meeting 7 p.m.
- November 8 - 4-H enrollment opens
- November 11 - Veteran's Day - Extension office closed
- November 23 - 4-H Council meeting 7 p.m.
- November 30 - Martha & Don Romeo Scholarship due
- TBD - Year-end celebration

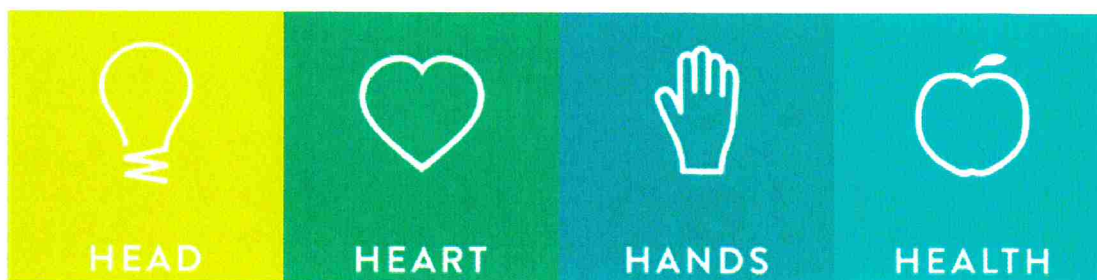

Extension is a Division of the Institute of Agriculture and Natural Resources at the University of Nebraska-Lincoln cooperating with the Counties and the United States Department of Agriculture.

University of Nebraska-Lincoln Extension educational programs abide with the nondiscrimination policies of the University of Nebraska-Lincoln and the United States Department of Agriculture.





Buffalo County 4-Hers invited to celebrate National 4-H Week

Join us on Facebook at [BuffaloCountyNebraska4-H](#) to celebrate 4-H!



Clover Kid contest

Traditional contest

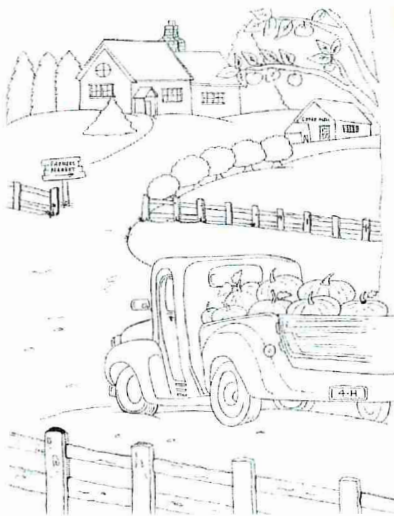

Monday - kickoff 4-H Trivia week

For each question answered correctly your name will be entered into a drawing to win a prize. Post your answers on Buffalo County 4-H Facebook page. Make sure your post is listed as a 'public post' so that we can see it on our page. A new question will be posted each day.

Tuesday, Oct. 5 - Clover Kid/Traditional 4-Her Coloring contest winners selected

All pictures will be displayed in our Extension office windows for the week and a prize will be given to one lucky Clover Kid and one Traditional 4-Her. Completed coloring pages can be dropped off or mailed to us at 1400 E 34th St. Kearney, NE 68847 by Friday, October 1st.

Wednesday, Oct. 6 - 4-H apparel day

Wear your 4-H T-shirt to show your 4-H pride!

Thursday, Oct 7 - Candy Jar

Guess how many pieces of candy are in our jar by posting your guess on Facebook. Person with closest guess wins the jar!

Friday, Oct 8 - Trivia winner announced



Roles available on 4-H Council

Interested? Know someone who would fit one of these roles? Call Extension at 308-236-1235.

Activities

Coordinate the annual 4-H Recognition Banquet and assist with recruitment and retention activities sponsored by 4-H Council.

Two-year term

4 Youth Reps.

Represent youth interests, aid in recruitment and retention activities and other events as assigned. Youth must be 12 years old (4-H age) to be considered. Youth are elected by ballot as are adult council members.

One-year term

What is the 4-H Council?

The Buffalo County 4-H Council is an essential group of adults and youth volunteers who meet, on the fourth Tuesday of most months in the evening, to evaluate and plan 4-H programs, events and fundraisers, set policies, and decide upon other 4-H management issues.

Individuals who are interested in making 4-H a growing and thriving program may consider the following positions:

Vice-President/ President Elect:

Duties include presiding at council meetings in the absence of the President and serving as Chair of the Nominating Committee. The Vice-Pres./Pres.-Elect shall be elected each year.

One-year term

Treasurer

Manage financial duties of council.

Two-year term

4-H Council Members

President: Zach Fries
Vice President: Megan Adkins
Past President: Christie Jones
Secretary: Josh Meier
Treasurer: Kris Shoemaker
FCS/STEM: Karmynn Andrews

Agriculture: Sarah Rolfsmeyer
Shooting Sports: Heidi Darby
Activities: Pat Hellriegel
Key Recruiter: Kaci Wozniak
Youth Members: Claire Gangwish
Nathan Gorecki
Keri Smith
Gracie Wagoner



Election: November 7th

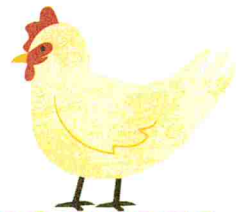

SAVE THE DATES

2022 Buffalo County Fair is July 19-26

Become a 4-H Youth Ambassador

We would like to invite all high school age 4-H members to be part of the Nebraska 4-H Youth Leadership Ambassador Team. As part of this group, you can:

- Be a voice on the youth perspective
- Develop and practice leadership skills that can be taken back to your communities
- Collaborate with Extension staff and 4-Hers across the state to plan and implement the 2022 4-H Youth Leadership Conference.



**APPLICATION DEADLINE IS
OCTOBER 15, 2021**



APPLY AT:

<https://go.unl.edu/2022ylcapp>

If selected, the first meeting will be Sunday, November 7, 2021 at 4-6 p.m. via Zoom. Then we will meet monthly to create an amazing experience for you and other high schoolers across the state! For questions or more information, please contact Julie Kreikemeier at julia.kreikemeier@unl.edu or Stacey Keys at stacey.keys@unl.edu.

4-H Youth Leadership Conference June 24-26, 2022





Raise funds for CWF trip

All Buffalo County 4-H members will again have the opportunity to fundraise this fall by selling fruit, meat, cheese and nuts. The focus of the fundraiser is to raise money for the bi-annual Citizenship Washington Focus trip. The fundraiser will start in mid-October and run until mid-November, with a delivery date of early December. The exact dates are to be determined.



4-H members would be responsible for:

- Selling the food items
- Collecting the money
- Picking up the items sold
- Delivering items to customers

Any 4-H member interested in fundraising should contact Jenny at the Buffalo County Extension Office, by calling 308-236-1235 or emailing jenny.kreikemeier@unl.edu.

Too young for CWF trip?

Any 4-H member is eligible to fundraise, even if they are too young to go on the CWF trip. Fundraising for multiple years is a great way to pay for this trip. Funds raised will be set aside in a Buffalo County 4-H Council account, specifically for that member.



Martha and Don Romeo scholarship open to 2022 graduates

The Nebraska Association of Fair managers would like present the Don and Martha Romeo Scholarship to one qualifying 4-H male and one qualifying 4-H female who are graduating seniors in the State of Nebraska and who plan to continue with post high school education for the amount of \$500 each. The scholarship will be awarded at the annual NAFM convention in January.



Applicants will be considered by following criteria:

- **Must have exhibited his/her 4-H projects in a County Fair or at the State Fair within the last four years.**
- **Hold a 2.5 high school grade point average (based on a 4.0 system) and also maintain a 2.5 grade point average for the first semester in college and carry at least 12 credit hours.**
- **Agree to apply the scholarship funds for tuition or fees at a two or four year college or its equivalent.**
- **Must have demonstrated support for his/her school and community.**
- **Exhibit during the application process a desire to achieve the goals of which he/she is capable.**
- **Financial need will not be considered in the selection process.**
- **One male and/or female finalist will be selected by the 4-H award committee in each local Extension Office.**
- **Requested to personally accept the award at the Nebraska Fair Managers Convention.**

**Deadline to apply:
November 30**

**To apply, visit
buffalo.unl.edu**



FEATURED RECIPE BY: CAYDEN FREY



CHOCOLATE BUNDT CAKE

INGREDIENTS

FOR THE CAKE:

- 8 ounces (2 sticks) unsalted butter, plus more for pan
- 2 1/4 cups all-purpose flour
- 3/4 cup unsweetened cocoa powder
- 1 teaspoon baking soda
- 1 teaspoon salt
- 1/2 cup milk
- 1/2 cup sour cream (4 ounces)
- 1 1/2 cups sugar
- 4 large eggs
- 1 teaspoon pure vanilla extract

FOR THE GLAZE:

- 4 Tablespoons cocoa powder
- 3 Tablespoons butter
- 1 cup powdered sugar
- 1/2 teaspoon pure vanilla extract
- 2 Tablespoons milk

Attention 4-Hers: If you would like to share a favorite recipe, email Jenny at jenny.kreikemeier@unl.edu

DIRECTIONS

Step 1

Make the cake: Preheat oven to 325 degrees. Butter a 14-cup Bundt pan. In a large bowl, whisk together flour, cocoa, baking soda and salt. Mix milk and sour cream in a glass measuring cup.

Step 2

With an electric mixer on medium-high speed, beat butter and sugar until pale and fluffy, 3 to 5 minutes. Add eggs, 1 at a time, beating well after each addition; add vanilla. Reduce speed to low; add flour mixture in 2 batches, alternating with the milk mixture and beginning and ending with the flour; beat until just combined.

Step 3

Transfer batter to prepared pan; smooth top with an offset spatula. Bake until a cake tester comes out clean, about 55 minutes. Transfer pan to a wire rack to cool completely.

Step 4

Make the glaze: Place chocolate in a heatproof bowl. Bring cream to a simmer in a small saucepan; pour over chocolate. Let stand 2 minutes. Add butter, and mix until smooth. Let stand, stirring occasionally, until slightly thickened. Pour glaze over cake.

4-H inspires
kids to do



4-H enrollment begins November 8th



All youth and
volunteers
need to
register

ENROLLMENT FEES



Clover Kids: \$5

Clover kids are youth ages 5 to 7, as of January 1, 2022.

Traditional 4-H members: \$10

Traditional 4-H members are youth ages 8 to 18, as of January 1, 2022.

- Families with multiple enrollees have a maximum fee of \$30
- Cash or check payments can be dropped off or mailed to the Extension office
- Online payments can be made at squareup.com/market/buffalo-county-4-h-council



EXTENSION



- Youth Development
- Diversity
- Partnerships
- Volunteerism



Nebraska Extension - Buffalo County
1400 E. 34th St.
Kearney, NE 68847
PHONE: (308)-236-1235
WEBSITE: buffalo.unl.edu

Buffalo County 4-H

June 2021 Newsletter

UPCOMING DEADLINES

JUNE 15TH: 4-H Enrollment

<https://ne.4honline.com>

JUNE 15TH: 4-H Enrollment Fee

squareup.com/market/buffalo-county-4-h-council

JUNE 15TH: County Animal ID sheets due to the office

extension.unl.edu/statewide/buffalo/livestock-resources/

JUNE 15TH: Quality Assurance Certificates due to the office

ygca.learn-grow.io

JUNE 15TH: State Fair Dairy ID

Sheets due to the office

extension.unl.edu/statewide/buffalo/livestock-resources/

JUNE 15TH: DNA Envelopes turned into the office

JUNE 15TH: State Fair Nominations
showstockmgr.com

IMPORTANT DATES

June 01 - 4-H Youth Leadership Conference Registration Deadline
June 01 - FCS PAT Meeting, 5:30 p.m.
June 01 - Horse, Small Animal, Shooting Sports, and Livestock PAT, 7 p.m.
June 02 - Junior Temp, Taste, and Try
June 03 - Clover Kid Culinary Workshop
June 07 - Junk Drawer Robotics Workshop Registration Deadline
June 08 - 4-H Speech and PSA Contest
June 09 - Beginning Culinary Workshop
June 09 - Lottery Pig Meeting, 6 p.m.
June 09 - Clover Kid Adventure Day Registration Deadline
June 10 - Presentation Contest Registration Deadline
June 10 - Lottery Goat Meeting, at 5:30 p.m.
June 11 - Junk Drawer Robotics Workshop, CCC
June 14 - District Horse Show, Scottsbluff
June 15 - District Horse Show, Burwell
June 15 - All Livestock and Horse ID's Due (includes Rabbit and Poultry)
June 15 - State Fair DNA Envelopes and Breeding nomination cards due to the office
June 15 - State Fair Online Nominations Due
June 15 - 4-H ENROLLMENT DEADLINE
June 15 - Quality Assurance Deadline
June 15 - State Hippology/Horse Judging Entries Due
June 16 - District Horse Show, Columbus
June 16 - Clover Kid Adventure Day, (ages 5-7)
June 16 - Culinary Challenge Registration Deadline
June 17 - District Horse Show, Lincoln
June 18 - NE Livestock Judging Classic
June 18 - Buffalo County Livestock Judging Contest
June 18 - District Horse Show, McCook
June 19 - Buffalo County 4-H Horse Show Invitational, 7 a.m. Registration
June 21 - Pre-Fair Entries open
June 22 - 4-H Council Meeting, 7 p.m.
June 22 - Lottery Goat Meeting, 5:30 p.m.
June 22 - Advanced Culinary Workshop
June 22 - Fashion Show Entries Due
June 23 - Fair Entry Q & A at 7 p.m.
June 24 - Presentation Contest, 7 p.m.
June 26 - Buffalo County Poultry Progress Show
June 28-29 - PASE/Life Challenge Contest
June 30 - Culinary Challenge
June 30 - State Public Speaking Contest

Extension is a Division of the Institute of Agriculture and Natural Resources at the University of Nebraska-Lincoln cooperating with the Counties and the United States Department of Agriculture.

University of Nebraska-Lincoln Extension educational programs abide with the nondiscrimination policies of the University of Nebraska-Lincoln and the United States Department of Agriculture.

UNIVERSITY OF
Nebraska
Lincoln

Enroll Now

Enroll now at <https://ne.4honline.com>. In order to participate at the 2021 Buffalo County Fair, youth need to be enrolled by June 15.

The annual enrollment fee for Clover Kids is \$5. Clover Kids are youth ages five to seven, as of January 1, 2021. The annual enrollment fee for traditional 4-H members is \$10. Traditional 4-H members are youth ages eight to eighteen, as of January 1, 2021. There is a family enrollment fee maximum of \$30. Payments in the form of cash or check can be dropped off or mailed to the Extension Office. Payments made online are done through this website: squareup.com/market/buffalo-county-4-h-council.

Select T-Shirt Size

When enrolling in 4-H online (<https://ne.4honline.com>), please make sure to fill out the t-shirt size. We will be going off of these sizes when ordering shirts this year. If you have already enrolled, please double check the size is correct. You can find the t-shirt selection under "Additional Information".

Volunteers

All NEW Buffalo County volunteers must complete the online volunteer screening, before volunteering. Once you complete the online enrollment at <https://ne.4honline.com>, Amber will send you an email with further instructions on completing the online volunteer screening.

ALL club leaders need to enroll online every year. Please go to <https://ne.4honline.com> to enroll. The 4-H enrollment and a volunteer background check needs to be COMPLETED before you start volunteering.

4-H Schedule and Fair Premium Book

The 2021 Buffalo County Fair is Tuesday, July 20th, through Tuesday, July 27th. The 4-H Schedule and 4-H Premium Book are available on our website: extension.unl.edu/statewide/buffalo/fair-premium-book/

The Premium Book is a great resource when making decisions about summer fair projects. The premium book will not be printed, but is available online at extension.unl.edu/statewide/buffalo/fair-premium-book/. Or you can stop by the Extension Office and we can print the areas needed.

Remind Notifications

Are you wanting text reminders for upcoming deadlines? Will you want updates that are happening during the fair? Join our group(s) on Remind.

To join the general group, send a text that says @bc4hgen to 81010. In this group you will be getting notifications such as: Animal ID Sheets are due June 15th. Don't forget to enroll by June 15th. Contest registration deadlines. We have other groups to join for animal classes, if you joined last year you will not need to rejoin.

To join for General updates text @bc4hgen to 81010.

To join for Goat updates text @goatshow3 to 81010.

To join for Horse updates text @horseshow3 to 81010.

To join for Market Beef updates text @mktbeef2 to 81010.

To join for the Monday Beef show updates text @mondaybeef to 81010.

To join for the Poultry updates text @poultrybc2 to 81010.

To join for the Rabbit updates text @rabbitbc3 to 81010.

To join for Sheep updates text @sheepshow2 to 81010.

To join for Small Animal updates text @smallanim3 to 81010.

To join for Swine updates text @swineshow4 to 81010.

If you have questions regarding the Remind Notifications please contact the office.

Pre-Fair Entries

Pre-fair entries will only be accepted online. This includes ALL static exhibits and ALL animal exhibits. Online entries will only be accepted from June 21st through July 1st. **NO LATE ENTRIES WILL BE ACCEPTED.** To enter, please go to <https://buffalo.fairwire.com/>. An **email** will be sent with more instructions around the June 21st date. For any questions please contact the Extension Office at 308-236-1235.

Buffalo County 4-H

Static Interview Judging Sign-Up Starting July 1st

Starting July 1st, sign-up for interview judging times for static exhibits through the Buffalo County Extension Office. Exhibitors may call the office at 308-236-1235 on or after Thursday, July 1st (when pre-entries are due), to schedule their times. Each 4-H'er may sign up for a maximum of three time slots. Note: You may sign up for horticulture interview times on entry days, as has been done in the past. Horticulture interview times are in addition to the three static interview times.

Pie and Decorated Cake Auction

Thursday, July 22nd at 5:30 P.M.

Buffalo County Fairgrounds Exhibit Building

The Buffalo County FCS Project Action Team will once again sponsor a Pie and Decorated Cake Auction at the 2021 Buffalo County Fair. The top two junior and senior decorated cakes and pie entries in the "Discovering Pies" and "Cooking 401" project areas will be eligible for auction to the highest bidder.

To be eligible, youth must be an enrolled 2021 Buffalo County Member, 4-H age of 8-18, enrolled in the "Discovering Pies", "Cooking 401" or "Decorated Cake" project areas, and have met all project entry criteria and deadlines. In addition, the pie or cake must be sold by the 4-H owner who entered it. If the 4-H member is not present for the auction, they are not eligible to participate. Only one item per 4-H member is eligible for auction.

One-half of the money raised per pie/cake will go to the pie-owner and the other half will go to the Buffalo County 4-H Council scholarship fund and the FCS Project Action Team in order to fund local FCS programs. To ensure success in selling your pie, talk to businesses, family members or other interested people. Extend a personal invitation to the auction and explain its importance.

Static Exhibits

All non-animal exhibits are called static exhibits. To exhibit in the 4-H project areas, members **MUST** be enrolled in the respective project.

Static exhibits will need to be pre-registered, by July 1st and checked in during Static Exhibit Check-In.

Static Exhibit Check-In is Tuesday, July 20 from 4-7 pm
(Everything)

ONLY Foods and Horticulture will be accepted on
Wednesday, July 21

Foods from 7 to 8 am

Horticulture from 7 to 9:30 am

4-H County Fair Scavenger Hunt

Are you ready for some fair time fun? Grab your friends and head to the county fair to start completing "missions" for the county fair scavenger hunt game! We will be utilizing the free "GooseChase" app for this activity with up to 25 missions for you to complete. To add to the fun of the hunt, the app features a LIVE feed where you can see what other teams are accomplishing, all while learning more about the county fair!

Who can play? Any fair-goer! These missions are not specific to 4-H membership. It is our hope that this game encourages others to learn more about 4-H and the county fair! There is no pre-registration for this event. Find the code for the game when you arrive at the Extension building on Thursday, July 22nd. The code will be posted at a central location for all to see.

Ready to participate? Download the GooseChase App on a mobile device to participate and check it out at the fair. Participate in the scavenger hunt when it works best for you using the game code provided. Each team can use up to 5 mobile devices. It is anticipated the hunt may take up to 1 ½ hours to complete depending on how many missions you choose to complete.

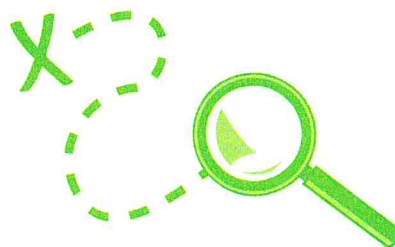

4-H Information Booth

Sign-up to work the 4-H Information Booth at the 2021 Buffalo County Fair. Those who sign up for a 2-hour time slot will receive a **FREE MEAL** coupon from the 4-H food stand! This opportunity is used to supervise the static exhibit displays in the Buffalo County Extension Building and provide information about 4-H to the public, who visit the building. It is also fun to have time to see all of the exhibits and get ideas for next year! Two people are needed for each two-hour shift. Please try to fit this into your fair schedule to help protect your exhibits and promote 4-H. Call the Extension Office to claim your slot.

County Fair Volunteer Opportunities

4-H Static Exhibit judging would not be possible without the help of numerous dedicated volunteers. Helping with static exhibit entry and judging is a great way to learn about the judges' expectations and discover project ideas for next year. Various shifts are available and are described below.

Contact the Buffalo County Extension Office at 308-236-1235 or Kameran Ulferts at kam.ulferts@unl.edu.

Static Exhibit Entry

Tuesday, July 20th, 4-7 P.M.

20 to 25 adults and youth (ages 12 and older)

Duties include checking-in and organizing 4-H static exhibits

Static Exhibit Entry and Judging

Food Entry Wednesday, July 21st, 7 A.M. – 8 A.M.

Static Exhibit Judging: 8:30 - until done

40 to 50 adults and youth (ages 12 and older) at different times throughout the day

Duties include checking-in and organize static exhibits, preparing judge score sheets and display exhibits

Release Exhibits and Clean-up

Monday, July 26th, 5:30 – 7 P.M.

10 to 15 adults and youth (ages 12 and older)

Duties include grouping exhibits by name and tearing down display pieces

Quality Assurance Training

ATTENTION ALL ANIMAL EXHIBITORS!

(Market Beef, Breeding Beef, Stocker Feeders, Dairy Goat, Dairy Cattle, Breeding Does, Market Goats, State Fair Poultry, State Fair Rabbits, Market Sheep, Breeding Sheep, Market Swine, and Breeding Swine)

In order for the 4-Hers to access YQCA online training their enrollment in 4-H Online must be active. You can find the online YQCA course at yqca.learnrow.io. Please use the same login information that you use in <https://ne.4honline.com> to login into yqca.learnrow.io.

When the 4-Her completes the online training they will need to print off the completion certificate and bring it to the Extension Office or email the certificate to Elizabeth at elizabeth.jones@unl.edu. All certificates must be turned in by Tuesday, June 15th. The youth must be enrolled in 4-H to take the YQCA training.

Premise ID Needed

Any new members, or anyone that has moved, showing a Market animal will need to have a premise ID. To obtain one, please call 402-471-2351 and you will be asked the address where the livestock are being housed. Please call 308-236-1235 or email amber.gapp@unl.edu and give us your premise ID number.

Carcass Contest Update

Due to the inconsistency in scanned data and increased costs there will NOT be any carcass contests during the 2021 Buffalo County Fair.

Hog Wash-Rack Update

Due to the delay of materials, the Hog Wash-Rack update might be delayed. There WILL be wash-racks, but they might be the old ones for the 2021 fair.

County Class Changes

This year there will be **NO class changes once animals have stepped off the scale**. For example: Market Beef animals designated to show as Bred and Fed or in the Market Beef Division will not be allowed to switch divisions.

Animal Identification Forms

All county fair animal identification sheets can be found online at extension.unl.edu/statewide/buffalo/livestock-resources/, or can be picked up at the Extension Office. ID sheets are due to the Extension Office by June 15. ID sheets are needed for horse, swine, beef, goats, dairy cattle, sheep, rabbits, and poultry.

Fair Schedule Changes

Horse Show Order – Wednesday, July 21. (Speed events, English, Showmanship, and Western)

Clover Kid Adventure Day

Extension Building, Kearney

Wednesday, June 16th 9 a.m. – 12 p.m.

Registration Deadline: June 9th

Cost: \$20

Explore the world of 4-H during this morning workshop! This workshop is geared toward the age of Clover Kids-ages 5-7.

Youth will leave with 4 different clover kid projects to bring to the fair! The projects will be paper sculptures, insect model, model magic animal, and creating a 4-H poster.

Register at: <https://form.jotform.com/61524848335157>.

**Junk Drawer Robotics
Central Community College
Friday, June 11th 9 a.m. – 12 p.m.
Registration Deadline: June 7th
Cost: \$15**

Are you wanting to learn more about robotics? Do you want to have a hands on learning experience? Come join us on Friday, June 11th for a Junk Drawer Robotics workshop. This will be held at Central Community College from 9 a.m. - 12 p.m. The fee is \$15 and space is limited. This workshop will be geared for ages 9 -13.

Register at: www.jotform.com/build/71165380018148.



**Culinary Challenge Contest
Extension Building, Kearney
Wednesday, June 30th
Register by June 16th**

Set-up 8:30 a.m.; Contest at 9:00 a.m.

Show off your party planning skills with this unique pre-fair contest open to all ages! Plan a menu suitable for an indoor or outdoor meal. Youth have the option to compete individually or as a team of two.

Individual County Division:

Members prepare one food item from the menu at home and bring it along with selected table service, two display cards and your own card table/eating area. The food may be an individual serving or for family service. Recipes may be from any source. The table service will include dishes, flatware and table linens for two place settings plus centerpiece. Paper plates are acceptable. The display cards should be approximately 4 inches by 6 inches. Print or type the situation and complete menu on one card, and the recipe on another. Display will be set up independently of adults. Members will be asked questions concerning the preparation, menu or choice of table service. Dress should be appropriate for category.

Culinary Challenge Team Division:

Teams of two must use the challenge ingredient: HONEY and table presentation interview must incorporate technology. All other guidelines follow the individual division of the Culinary Challenge contest. Culinary Challenge Team winners advance to state, if they meet eligibility requirements.

Call the Extension Office by Wednesday, June 16, to register for this contest. For more information:

extension.unl.edu/statewide/buffalo/whats-happening-in-4-h/.

4-H Q and A

**Wednesday, June 23rd at 7 p.m.
Buffalo County Extension Building**

You're enrolled in 4-H.. now what? Join us this evening to have all your fair entry questions answered. Allow us to walk you step by step through the necessary steps of entering exhibits into the fair.. livestock and static exhibits!

Bring the youth in your lives to this Q&A at the office- we will have a special activity planned for them in our conference room (with the help of a 4-H professional).

If you're unable to join in person, there is a Zoom option! Please register to let us know how you will be joining.

<https://unl.zoom.us/j/7558458458>



**Presentation Contest
Extension Building, Kearney
Tuesday, June 24 at 7 p.m.**

Registration Due Thursday, June 10th

Learn lifetime speaking and demonstration skills during this contest and win some cash at State Fair! Prepare and give a live presentation with a formal talk using visual aids to show and tell others how to do something. Topics need to be related to 4-H. Categories include Illustrated Presentation, Teaching Presentation and 4-H FilmFest. Everyone can compete at the county level and those 10 years of age and older as of January 1, 2021 are eligible to compete at the State Fair. There is some cash to be won at the State Fair level! Each county can send their top individual or team to the State Fair as Premier Presenter(s). More details are available at

<https://extension.unl.edu/statewide/buffalo/fair-premium-book/>. To register go to

https://ssp.qualtrics.com/jfe/form/SV_8w9gAOECz0Rmlue.

Buffalo County 4-H

Fashion Show Modeling Tuesday, July 6 at 7 p.m. UNK, Fine Arts Building

Registration Due Tuesday, June 22nd

Are you interested in showing off the clothing items you made for fair? Does modeling interest you? If you said yes to either of these consider participating in the 2021 Buffalo County Fashion Show on Tuesday, July 6th at UNK! This county contest is open to any 4-H member enrolled in a clothing project. 4-H'ers are invited to model their clothing creations or purchased garments. The judging and the public show will take place at the same time, starting at 7 p.m. All participants are welcomed to come to the auditorium on campus for practice runthroughs before the show, starting at 5:30 pm. Practice before the show is highly encouraged but not required. See the fair book for program details at buffalo.unl.edu. The evening 4-H Fashion Show is free and open to the public.

To Register go to: <https://go.unl.edu/fashionshowentries>

State Hippology Contest

The 2021 State Hippology Contest Registration forms are due to the Extension Office by Tuesday, June 15th. There is a \$10 registration fee. For more information and to find the entry form go to <https://4h.unl.edu/state-horse-expo-contests#hippology>. All exhibitors will be required to wear a mask while at the contest(s).

State Horse Judging Contest

The 2021 State Horse Judging Contest Registration forms are due to the Extension Office by Tuesday, June 15th. There is a \$10 registration fee. For more information and to find the entry form go to <https://4h.unl.edu/state-horse-expo-contests#judging>. All exhibitors will be required to wear a mask while at the contest(s).

Life Challenge June 28-29

Nebraska Extension 4-H Youth Development hosts PASE/Life Challenge, June 28-29, on the University of Nebraska-Lincoln's East Campus. This event is open to 4-H youth ages 10-18. Youth interested in Family and Consumer Sciences will have the opportunity to compete in challenges and contests and stay on campus. For additional information or if interested in participating in Life Challenge, please call the Extension Office, 308-236-1235.

Please let us know if you are interested by June 7th.

State Fair Animal Nominations

Exhibitors interested in showing at state fair will need to do online nominations.

All market animals (beef, swine, sheep, and goats) have until June 15th at 5 p.m. to turn in their DNA envelopes to the extension office and nominate their animals online at showstockmgr.com. Payment must be submitted to be eligible to show at state fair.

Anyone interested in showing breeding animals (beef, swine, sheep, goats) will need to turn in breeding nomination cards as well as nominate their animals online at showstockmgr.com by June 15th at 5 p.m. Payment must be submitted to be eligible to show at state fair.

If you have any question, please contact the extension office at 308-236-1235.

5th Annual Agronomy Youth Field Day

See crop management & weed control DRONE demonstrations! FLY a drone thru an obstacle course! Learn if your soil is healthy. Do your plants have diseases? These hands-on activities for youth ages 9-18 from across the state will happen at the 5th Annual Agronomy Youth Field Day in Curtis, NE on July 7, 2021. The youth field day will focus on drone weed control, planter technology, using drones for crop management, creating healthy soil, & plant disease ID.

The six-hour field day is a great opportunity for youth statewide to gain important life skills while learning about careers in science and agronomy, irrigation, and mechanized agriculture.

The interactive sessions will be organized in two tracts: one for youth ages 9-11 years and one for youth ages 12-18 years. The sessions include field, laboratory and classroom activities.

Register online by July 1, 2021 at:

<https://go.unl.edu/agronomyyouthfieldday>. For more information contact Nebraska Extension Frontier County at 308-367-4424 or email Kathy Burr at kathy.burr@unl.edu

All upcoming shows and clinic information, including registration, are listed on our website: buffalo.unl.edu. Flyers are also available in the Extension Office.

February 12, 2021
Kerry Elsen
Buffalo County Extension
For Immediate Release

Buffalo County 4-H Wants You

With the school quickly winding down and the feeling of spring in the air, it is time to determine how we will all be spending our time the next few months. If you are looking for a way to be involved as a family, learn new skills and be able to exhibit at the Buffalo County Fair, joining 4-H is a great option for you. All youth between 5-18 are eligible to be involved in 4-H.

The mission of Nebraska 4-H is to empower youth to reach their full potential working and learning in partnership with caring adults. There are a variety of ways to participate in 4-H, camps, traditional clubs, school enrichment, afterschool programs, special interest programs and independently. 4-H has more than 150 projects to choose from; Robotics, Photography, Shooting Sports, Cooking, Visual Arts, and Companion Animals just to name a few. Whatever your area of interest is, there is a place for you in 4-H.

In addition to opportunities for youth, adults are needed as volunteers. Do you have a skill you are willing to teach others? Do you enjoy working with youth and have time to ensure extra hands are available during a workshop? Volunteer time commitments can range anywhere from a few hours at a workshop to a more involved leader of a traditional club.

To be eligible to participate in the 2021 Buffalo County Fair you need to be enrolled by June 15th. To get more information on joining 4-H visit,

<https://extension.unl.edu/statewide/buffalo/>, call 3080-236-1235, or

kerry.elsen@unl.edu. We are happy to help you find the right project area and help you walk through the enrollment process. The opportunities are endless in 4-H!

Ranae L. Aspen
Media Release for Immediate Use
9/3/2021

September is Family Meal Month. If you are like the majority of families, this can be a challenge. As kids get older, they become involved in extra- curricular activities and may even have part time jobs along with a full day of school. Parents are involved in their communities and work as well. Research shows us that it is very important to take time and have family meals.

Here are some benefits to having regular family meals together:

- Children who eat with their families tend to have better academic performance.
- Higher self-esteem. Meals are not just nourishment; they are a time to find out what is going on with one another. It also generates conversation about some of the tough things that may be happening in their school world.
- Family meals lower the rate of at risk behaviors like teen pregnancy and substance abuse.
- Family meals lower the risk of depression and eating disorders.
- Family meals lower the rate of obesity.
- Family meals also help your food budget, food waste and insures that you are eating healthy.

Time seems to be a major factor when families report that they do not eat meals together. The solution is not easy. You will need to look at a calendar with everyone's events and block off time for meals. In addition, if you attend a sporting event together as a family, you can be creative and have a family tailgate meal. The key components to family meal- time is food and being together, if you tailgate, this is fulfilling that definition.

Eating at fast food restaurants adds up. If you do a simple break down of cost of making homemade hamburgers versus going to a fast food restaurant, you will find that it is less expensive to make them at home and you control the sodium in the hamburger. Here is a quick breakdown:

- 80% lean hamburger, on sale for \$1.99 (4 servings, 4 ounces each)
- Hamburger Buns, on sale for \$1.00 (8 per package)
- Slice of American Cheese, slices on sale for \$1.75 (8 slices in package)

**TOTAL Cost of 1 hamburger: \$.86

A lot of this will be family communication that emphasizes the importance of coming together at the dinner table. As your children get older, you may have only 3-4 meals a week together and that is ok. Make the time count. Prepare the meal together, eat the meal together and do the cleanup of the meal together. Showing your family how important it is to eat together as a family will be a life-long behavior that will have good positive impact not only on your family but with future generations as well. Your children will grow up to have their own family and will implement the importance of eating together for their children as well.

Extension Column – June 25, 2021
Buffalo County Extension
Carol Schwarz, MS, RD
Extension Educator

Put a Lid on It! Closures for Home Canning

Many people are continuing to garden and can this summer, which has increased the demand for home canning jars and lids over the past few months. Well-known canning companies have streamlined production and expanded distribution capabilities to replenish stock as quickly as possible. They are currently supplying all their retail partners. The assortment and quantity may vary, so consumers are encouraged to check with other authorized retailers if a retailer is temporarily out of stock.

There are many inferior quality canning supplies available for consumers to buy. Be sure to read *all* the information listed for each product, as titles may be deceiving. To ensure quality, consider ordering directly from the manufacturer or their representative and not from a 3rd party vendor.

Traditional 2-piece metal lids are designed to be used only once. Unused lids should be stored in a cool, dry location and may be good for up to 5 years from the date of manufacture. Over time the sealing compound will degrade, and the lid may fail to seal. These best practice tips will help ensure that jars seal and stay sealed.

- Follow the manufacturer's directions for preparing lids. Traditionally, lids were simmered or boiled prior to applying to jars, but this is generally not the case now. Check the directions.
- Always wash and rinse lids and bands prior to use.
- Leave the proper headspace.
- Clean the jar rim (sealing surface) prior to applying the lid. Food or debris trapped on the jar rim can cause seal failures.
- Place the metal screw band over the flat lid and apply finger-tip tight. Screw bands that are applied too loose, or too tight, can cause jars not to seal properly.

After processing, remove jars from the canner and allow to cool, undisturbed. Do not retighten screw bands. Once jars are completely cool, check for seal. It is a good idea to remove screw bands for storage. When removed, washed, dried, and stored in a dry area, screw bands may be used many times. If left on stored jars, they become difficult to remove, often rust, and may not work properly again.

Recent research suggests that reusable lids such as the Tattler-brand will safely seal jars when used for home-based canning. This type of reusable lid is used with a thin rubber gasket. A metal screw band is also needed during canning! Follow these tips to help ensure that jars seal and stay sealed.

- Follow the manufacturer's instructions for use carefully. Instructions may vary from the traditional metal two-piece closure.
- Follow 'best practices' for using a metal lid and screw band, applying the lid, gasket and metal screw-band when sealing the jar.

Manufacturer's instruction *may* instruct the user to *tighten the metal band immediately upon removal from the canner. If instructed, do so.* Tightening the screw band ensures that the gasket forms a seal. The metal screw band is removed once the container is cooled, and a seal has formed.

To help ensure a jar seal, limit reusable lids to 10 canning trips. Use a permanent marker to mark each canning 'trip' for a reusable lid and gasket. Once '10 trips' have been marked, it is time to replace the lids (and gaskets). Always replace reusable lids and gaskets if cuts or tears are noticed in the material.

For more home canning information contact Nebraska Extension in Buffalo County, 1400 East 34th Street, Kearney NE 68847, or call (308) 236-1235.

Sources: University of Wisconsin Extension and Ball® websites

Use of commercial and trade names does not imply approval or constitute endorsement by the University of Nebraska-Lincoln Extension. Nor is criticism implied of products not mentioned.

For: Around the County
Brent Plugge
Date: February 3, 2021

Bull Buying Season: Using the Numbers for Genetic Advancement

Bull buying season is in full swing and with that comes lots of sale catalogs filled with lots of numbers. Those numbers are important as they help fulfill your objective of buying a bull to improve the genetics of your calf crop. Selection based on raw values places selection pressure not only on the genetic potential of an animal but also on environmental influences such as herd, year, season, and management, therefore bull selection should be based on EPDs and economic indices as these tools are far more accurate in predicting the average difference in offspring between bulls than visual appraisal or actual weights. Many producers mistakenly place more emphasis on these raw measurements than EPDs. Raw measurements include the confounded effects of genetics and environment, and consequently, the genetic ability of the animal is unknown.

Expected Progeny Differences (EPDs) allow for the comparison of animals within a breed for their genetic potential as parents for a given trait. EPDs have existed in the beef industry for decades and their use has produced intended genetic change in many traits. EPDs incorporate multiple sources of information, including full pedigree, an animal's own record, and progeny information. As additional sources of information become available, the accuracy of the EPD value increases. However, some producers are still reluctant to rely on EPDs when making selection decisions.

That said, it is completely unrealistic to expect all commercial bull buyers to completely understand all available EPD and economic selection indices. Commercial cattle producers have a cattle enterprise to run leaving little time to dedicate to understanding the intimate details surrounding genetic prediction. There are resources (e.g., www.ebeef.org) designed to help. Ideally, seedstock suppliers should also aid in the understanding and use of these tools.

Matt Spangler, University of Nebraska Beef Cattle Geneticist outlined a few key points in bull selection.

Have a breeding objective in mind. This should include how you plan to sell calves, if you plan on retaining replacement females, and any labor or other environmental constraints (e.g., limited forage). This helps identify the traits that are economically relevant to you.

Choose a breed (or breeds) that fit your current crossbreeding system and match your objectives. Compare breeds based on current research (i.e., US Meat Animal Research Center) and not a historical view as breeds have changed overtime.

Identify a seedstock supplier (or suppliers) that you trust and that have bulls for sale that match your breed needs and your breeding objective.

Identify bulls, based on EPD or (preferably) economic index values that match your objectives. If calving ease EPD exist, do not use birth weight EPD. Calving ease EPD are generated using birth weight information.

If you retain replacement females, pay attention to calving ease maternal EPD. These are really 'Total Maternal Calving Ease' EPD, and reflect how easily a bull's daughters will calve as two-year olds. Reproductive longevity is a key profit driver for self-replacing herds. If a Stayability EPD or Sustained Cow Fertility EPD exists, use it.

If you retain replacement females in limited feed environments, consider selecting bulls with more moderate mature weight and milk (maternal weaning weight) EPD.

Understand that even if you sell calves at weaning, someone is going to own them in the feedyard. If you want to build a market for your calves, do not completely ignore post-weaning gain and carcass merit.

Use an index that fits your objectives—this can greatly simplify bull selection decisions. Do not use a completely terminal index if you retain replacement heifers.

Buy quality, but do not overpay. Sometimes the bull that is not top on your list is actually the better economic decision.

Too often seedstock producers and bull buyers get caught up in the actual weights, ultrasound data, etc., when selecting sires. EPDs provide a measure by which animals within a breed can be compared to one another for their genetic potential as parents for specific traits. This bull sale season do not make the process more complex than it really needs to be and certainly do not get caught in the trap of believing that you can visually see the genetic potential of a bull—use the tools that science has provided and has continually improved and validated.

Youth + experiential learning activities = Life Skills Development

Happy Nebraska 4-H Month!

In the 118 years that 4-H has existed, being one of America's oldest and largest Youth Development organizations, it has stayed true to the four H's. According to the Targeting Life Skills Model, developed by the University of Florida IFAS Extension, the four H's are the "4-H Focus of Youth Competencies." They define a skill as a learned ability. "Life Skills are those competencies that assist people in functioning well in the environments in which they live". Explained in depth, the four H's are as follows:

HEAD: Knowledge, Reasoning and Creativity Competencies

Thinking: using one's mind to form ideas and make decisions; to imagine, to examine carefully in the mind, to consider.

Managing: using resources to accomplish a purpose.

HEART: Personal/Social Competencies

Relating: establishing a mutual or reciprocal connection between two people that is wholesome and meaningful to both.

Caring: showing understanding, kindness, concern and affection for others.

HAND: Vocational/Citizenship Competencies

Giving: providing, supplying, or causing to happen (social responsibility).

Working: accomplishing something or earning pay to support oneself through physical or mental effort.

HEALTH: Health/Physical Competencies

Living: Acting or behaving; the manner or style of daily life.

Being: living ones life; pursuing ones basic nature; involved in personal development.

The Targeting Life Skills Model further suggests that ***positive youth development programs*** identify the skills within the targeted competency areas that are appropriate to the age of the youth in the program and *offer experiences to teach* these skills. Because skills are best learned through practice, many experiences that teach or reinforce skills must be provided. Mastery of any skill requires **opportunities** to try, make mistakes, and try again.

What about 4-H specifically targets these skills? The answer lies within the experiential model used in 4-H programs. The steps within the experiential learning model:

1.) Experience, 2.) Share, 3.) Process, 4.) Generalize, and 5.) Apply

According to a Leader Guide resource created by Nebraska 4-H, Experiential Learning can occur when educators are purposeful in directing the youth experience and take time to reflect on what was learned. Through the steps of Experience, Share, Process, Generalize,

and Apply, youth are able to enhance and be engaged through their own learning. An important aspect of Experiential Learning includes active questioning:

1. What did the project mean to your everyday life?
2. Why was this project important to your life?
3. How will you act differently in the future as a result of this experience?
4. How can you use these skills or knowledge in different situations?

By putting youth in the driver's seat of their involvement, through hands-on experiential learning, educators and leaders can create memorable experiences that develop into life skills that can translate throughout their life from childhood to adulthood.

Are you interested in involving your child in 4-H Youth
Development in Buffalo County?

Enroll now! The first 30 folks who enroll in February will receive
a FREE 4-H yard sign!

Enroll here at this website or scan the QR code: Buffalo.unl.edu

Have questions? Call us! 308-236-1235

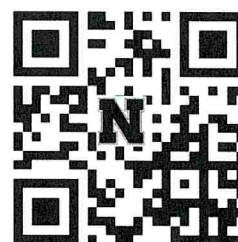

Want to see what we're doing in Buffalo County?
Follow us on **Facebook**: @BuffaloCountyNebraska4-H
-Prize giveaways will be posted the entire month of February!
Follow us on **Instagram**: @buffalocounty4h
Follow us on **Pinterest**: @buffalocounty4h

As always, please reach out to your local Nebraska Extension office in Buffalo County with any youth development questions, comments or concerns.

Kameran Ulferts
4-H Asst Educator
Nebraska Ext in Buffalo County
1400 East 34th St Kearney, NE 68847
308-236-1235

Janning, E. Scholtz, Krehbiel, M. "Expanded Learning Opportunities: Experiential Learning"
<http://extensionpublications.unl.edu/assets/pdf/ec485.pdf>

Hendricks, P. (1998) "Developing Youth Curriculum Using the Targeting Life Skills Model"
<http://www.extension.iastate.edu/4H/skls.eval.htm>

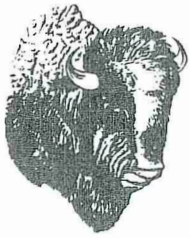

JEAN A. SIDWELL
Buffalo County Treasurer
Brenda R. Rohrich, Deputy
1512 Central Avenue
P O Box 1270
Kearney, Nebraska 68848-1270

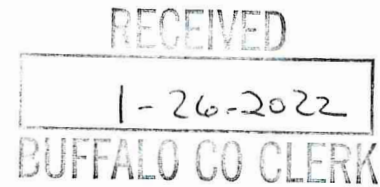

January 17, 2022

Buffalo County Board of Commissioners
Courthouse
Kearney, NE 68847

Dear Supervisors:

The attached exhibits are forwarded for your information in compliance with the Revised Statutes of Nebraska 1943, Sec. 77-1745. In part it reads:

“The County Treasurer shall settle with the County Board.....a statement showing the amount of money collected since last statement, from what source derived, amount of money paid out and for what purpose, together with the vouchers for the same, the amount of taxes due and unpaid and the amount of money on hand belonging to the several funds.”

Please be advised that due to the number and amounts of such warrants, it is very impractical to list and include them in this report. However, they are filed in the Clerk's and Treasurer's vaults and may be inspected at any time. The total disbursements and balances for the various funds are part of the Treasurer's semi-annual statement, a copy of which has been attached.

Yours very truly,

Jean A. Sidwell
Buffalo County Treasurer

Attachments

BUFFALO COUNTY TREASURER'S SEMI-ANNUAL REPORT
 JULY 1, 2021 THROUGH DECEMBER 31, 2021

<u>ACCOUNT</u>	<u>PRIOR BALANCE</u>	<u>DEBITS</u>	<u>CREDITS</u>	<u>CURRENT BALANCE</u>
All State Funds	\$1,184,337.63	\$6,075,914.47	-\$6,290,082.05	\$970,170.05
County Funds	\$23,966,298.75	18,743,596.10	-19,857,365.54	\$22,852,529.31
Visitor's Promotion	\$93,539.14	820,252.01	-801,154.00	\$112,637.15
All School Funds	\$1,283,218.42	37,731,053.82	-27,243,734.09	\$11,770,538.15
Special Assessment	\$0.00	14,553.92	-4,219.03	\$10,334.89
Municipal Fines	\$1,595.00	8,049.00	-8,544.00	\$1,100.00
ESU #10	\$9,907.22	470,337.32	-327,960.42	\$152,284.12
Central Comm College	\$60,774.65	2,890,532.89	-2,011,541.24	\$939,766.30
NRD Funds	\$15,422.11	749,210.09	-521,765.68	\$242,866.52
Fire Districts	\$6,416.75	421,078.71	-271,857.45	\$155,638.01
Sanitary Imprvmt Dist	\$302,546.61	26,988.54	-25,665.91	\$303,869.24
City/Village Funds	\$178,979.34	3,478,559.98	-2,825,425.48	\$832,113.84
Agricultural Society	\$11,252.56	536,062.12	-371,290.67	\$176,024.01
Partial Payment	\$41.15	4,793.29	-1,864.87	\$2,969.57
Escrow Funds	\$65,664.44	103,723.10	-9,852.25	\$159,535.29
State Apportionment	\$36,049.10	830.39	0.00	\$36,879.49
Community Rdvlpmt Auth	<u>\$3,609.92</u>	<u>1,557,319.28</u>	<u>-660,548.56</u>	<u>\$900,380.64</u>
	\$27,219,652.79	\$73,632,855.03	-\$61,232,871.24	\$39,619,636.58

County Clerk certification of
 unpaid County claims \$0.00

Cash and Investment: 39,619,636.58
 In Lieu 0.00
 39,619,636.58

I, Jean A. Sidwell, duly elected Treasurer of Buffalo County, do hereby certify that the above statement is true and correct to the best of my knowledge and belief.

Subscribed and sworn to me
 this 25th day of January, 2022.

Brenda R Rohrich

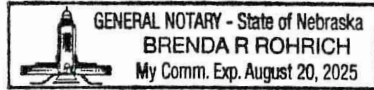

Jean A Sidwell

 Jean A. Sidwell, Buffalo County Treasurer

Neil A. Miller
Sheriff



Daniel J. Schleusener
Chief Deputy

BUFFALO COUNTY OFFICE OF THE SHERIFF

2025 Avenue A • P.O. Box 2228
Kearney, Nebraska 68848
Phone (308) 236-8555



January 31, 2022

Chairman Ivan Klein
Buffalo County Board of Supervisors
PO Box 1270
Kearney, NE 68848

The following information is being provided to you related to the Buffalo County Clerk's Office request to review the application for a Special Designated Liquor License-Non Profit Applicant; National Audubon Society. The SDL application is for a fundraising event that will be held at the Audubon Rowe Sanctuary located at 44450 Elm Island Rd. Gibbon, Buffalo County, Nebraska, on Thursday, April 7, 2022 from 5:30 p.m. to 9:00 p.m. The estimated number of attendees is 100 people. The application indicated the type of alcohol to be served will be beer and wine.

The application identified Catherine Worley of the Audubon Rowe Sanctuary as the immediate supervisor/contact for the event who would be responsible for ensuring that any applicable laws, ordinances, rules and regulations are adhered to.

Upon performing a brief background through Nebraska based and local data bases of Catherine Worley, there was no additional information of concern discovered.

Sincerely,
NEIL A. MILLER
Sheriff

A handwritten signature in black ink, appearing to read "Paul T. Koerner".

Paul T. Koerner
Investigator

cc: Sheriff Miller

**Special Designated License
Local Recommendation (Form 200)**

Applications must be entered on the portal after local approval – no exceptions
Late applications are non-refundable and will be rejected

National Audubon Society - Iain Nicolson Audubon Center

Retail Liquor License Name or *Non-Profit Organization (*Must include Form #201 as Page 2)

44450 Elm Island Road, Gibbon, NE, 68840

Retail Liquor License Address or Non-Profit Business Address

13-1624102

Retail License Number or Non-Profit Federal ID #

Consecutive Dates only

April 7th, 2022

Event Date(s):

Event Start Time(s):

5:30pm

Event End Time(s):

9:00pm

Alternate Date: N/A

Alternate Location Building & Address: N/A

Event Building Name: Iain Nicolson Audubon Center

Event Street Address/City: 44450 Elm Island Road, Gibbon, NE, 68840

Indoor area to be licensed in length & width: 50 x 50

Outdoor area to be licensed in length & width: 100 x 100 (Diagram Form #109 must be attached)

Type of Event: Fundraising event Estimate # of attendees: 100

Type of alcohol to be served: Beer Wine Distilled Spirits

(If not marked, you will not be able to serve this type of alcohol)

Event Contact Name: Catherine Worley Event Contact Phone Number: 308-468-5282

Event Contact Email: catherine.worley@audubon.org

*Signature Authorized Representative:  Printed Name Bill Taddicken

I declare that I am the authorized representative of the above named license applicant and that the statements made on this application are true to the best of my knowledge and belief. I also consent to an investigation of my background including all records of every kind including police records. I agree to waive any rights or causes of action against the Nebraska Liquor Control Commission, the Nebraska State Patrol or any other individual releasing said information to the Liquor Control Commission or the Nebraska State Patrol. I further declare that the license applied for will not be used by any other person, group, organization or corporation for profit or not for profit and that the event will be supervised by persons directly responsible to the holder of this Special Designated License.

*Retail licensee – Must be signed by a member listed on permanent license

*Non-Profit Organization – Must be signed by a Corporate Officer

Local Governing Body completes below:

The local governing body for the City/Village of _____ **OR** County of _____ approves the issuance of a Special Designated License as requested above. (Only one should be written above)

Local Governing Body Authorized Signature

Date

**APPLICATION FOR SPECIAL
DESIGNATED LICENSE
Non-Profit Applicants ONLY**

NEBRASKA LIQUOR CONTROL COMMISSION
301 CENTENNIAL MALL SOUTH
PO BOX 95046
LINCOLN, NE 68509-5046
PHONE: (402) 471-2571
FAX: (402) 471-2814
Website: www.lcc.nebraska.gov/
Email Applications: michelle.porter@nebraska.gov

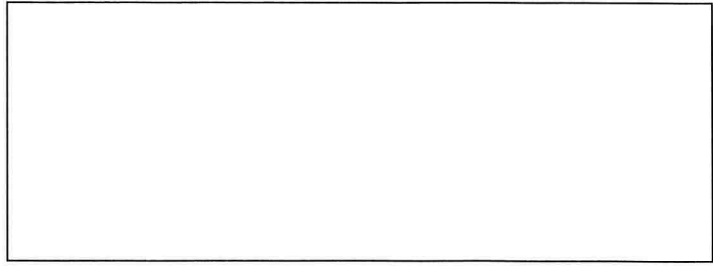

This page is required to be completed by Non-Profit applicants only.

**Application for Special Designated License
Under Nebraska Liquor Control Act
Affidavit of Non-Profit Status**

I HEREBY DECLARE THAT THE CORPORATION MAKING APPLICATION FOR A SPECIAL DESIGNATED LICENSE UNDER THE NEBRASKA LIQUOR CONTROL ACT IS EITHER A MUNICIPAL CORPORATION, A FINE ARTS MUSEUM INCORPORATED AS A NONPROFIT CORPORATION, A RELIGIOUS NONPROFIT CORPORATION WHICH HAS BEEN EXEMPTED FROM THE PAYMENT OF FEDERAL INCOME TAXES, A POLITICAL ORGANIZATION WHICH HAS BEEN EXEMPTED FROM THE PAYMENT OF FEDERAL INCOME TAXES, OR ANY OTHER NONPROFIT CORPORATION, THE PURPOSE OF WHICH IS FRATERNAL, CHARITABLE, OR PUBLIC SERVICE AND WHICH HAS BEEN EXEMPTED FROM THE PAYMENT OF FEDERAL INCOME TAXES AS PER §53-124.11(1).

AS SIGNATORY I CONSENT TO THE RELEASE OF ANY DOCUMENTS SUPPORTING THIS DECLARATION AND ANY DOCUMENTS SUPPORTING THIS DECLARATION WILL BE PROVIDED TO THE NEBRASKA LIQUOR CONTROL COMMISSION, THE NEBRASKA STATE PATROL OR ANY AGENT OF THE LIQUOR CONTROL COMMISSION IMMEDIATELY UPON DEMAND. I ALSO CONSENT TO THE INVESTIGATION OF THIS CORPORATE ENTITY TO DETERMINE IT'S NONPROFIT STATUS.

I AGREE TO WAIVE ANY RIGHTS OR CAUSES OF ACTION AGAINST THE NEBRASKA LIQUOR CONTROL COMMISSION, THE NEBRASKA STATE PATROL OR ANY PARTY RELEASING INFORMATION TO THE AFOREMENTIONED PARTIES.

National Audubon Society

NAME OF CORPORATION

13-1624102

FEDERAL ID NUMBER

Will Ill Director, Howe Sanctuary

SIGNATURE OF TITLE OF CORPORATE OFFICERS

THE ABOVE INDIVIDUAL STATES THAT THE STATEMENT ABOVE IS TRUE AND CORRECT: IF ANY FALSE STATEMENT IS MADE ON THIS APPLICATION, THE APPLICANT SHALL BE DEEMED GUILTY OF PERJURY AND SUBJECT TO PENALTIES PROVIDED BY LAW. (SEC. §53-131.01) NEBRASKA LIQUOR CONTROL ACT

SUBSCRIBED IN MY PRESENCE AND SWORN TO BEFORE ME THIS 25 DAY OF January, 2022.

Tara D Reasoner
NOTARY PUBLIC SIGNATURE & SEAL

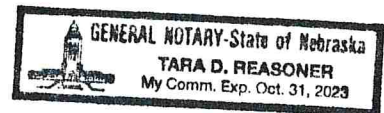

OUTDOOR AREA DIAGRAM

HOW AREA WILL BE PATROLLED See attached map

- IF APPLICABLE, OUTDOOR AREA MUST BE CONNECTED TO INDOOR AREA IF INDOOR AREA IS TO LICENSED
- MEASUREMENT OF OUTER WALLS OF AREA TO BE LICENSED MUST INCLUDED LENGTH & WIDTH IN FEET
- DOUBLE FENCING IS REQUIRED FOR ALL NON-PROFIT ORGANIZATIONS UNLESS FORM #140 IS FILED WITH THIS FORM AND IS APPROVED BY THE COMMISSION
- RETAILER LIQUOR LICENSE HOLDERS ARE NOT REQUIRED TO DOUBLE FENCE, ALTHOUGH MEASURES NEED TO BE TAKEN TO SECURE THE AREA

DIAGRAM OF PROPOSED AREA:

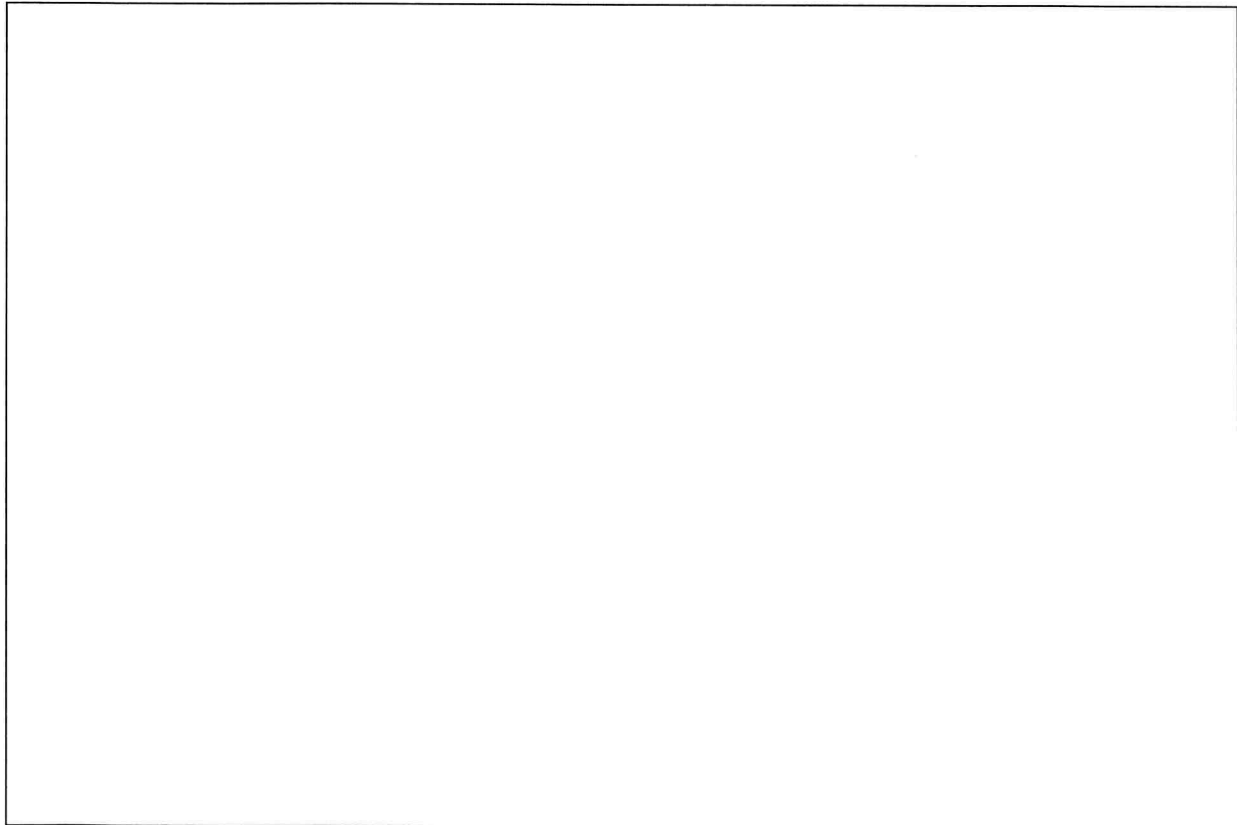

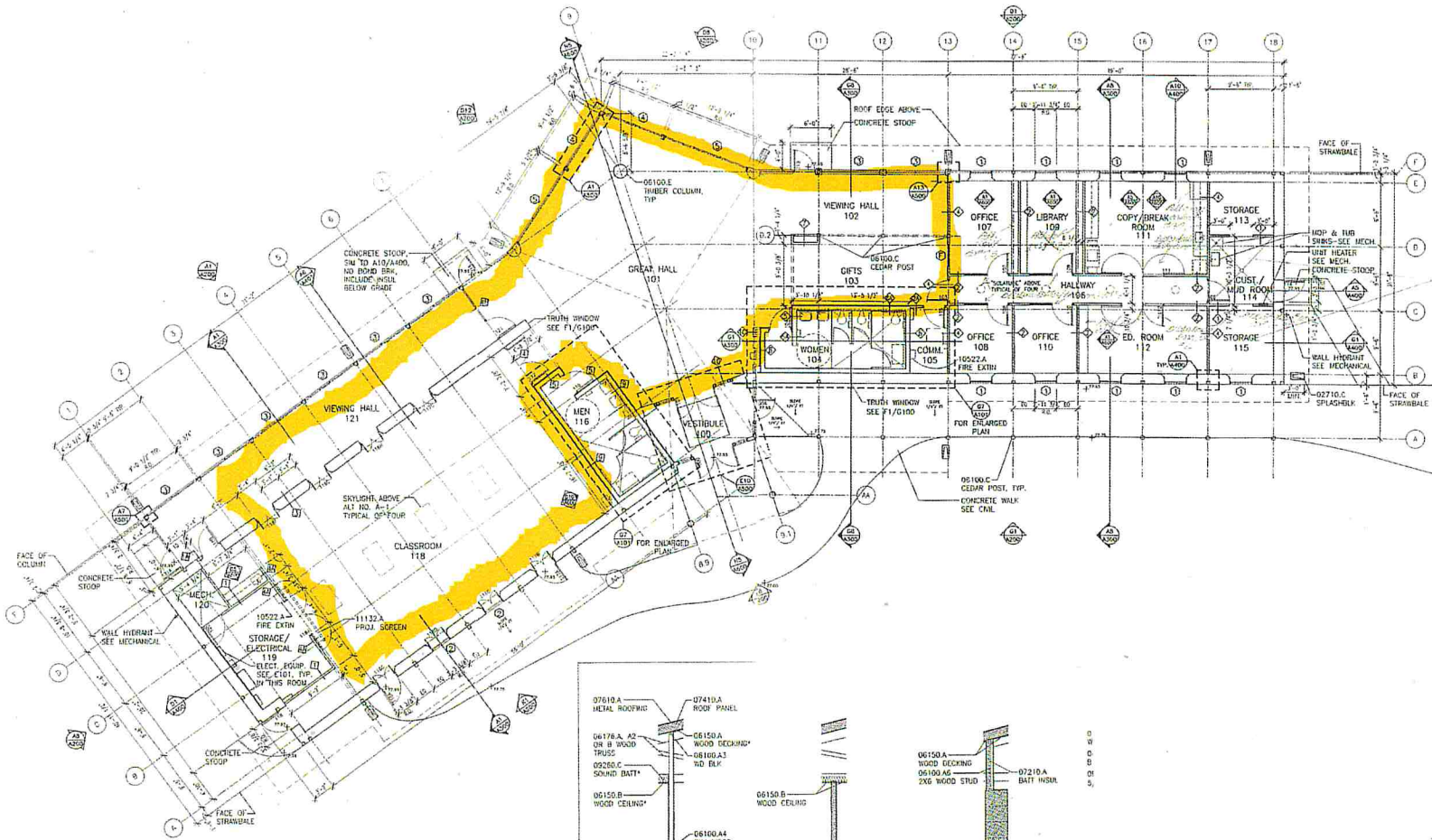

*All doors shown as
swing in unless
otherwise noted.*

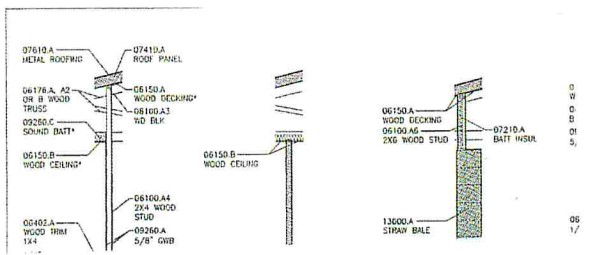

STRUCTURAL ENGINEER
WALTER H. CANTRELL
1000 W. WASHINGTON ST.
ANNAPOLIS, MD 21403
(410) 291-4800

MECHANICAL/ELECTRICAL ENGINEER
RICHARD H. CANTRELL
1000 W. WASHINGTON ST.
ANNAPOLIS, MD 21403
(410) 291-4800



RCH STUDIO
CTURE

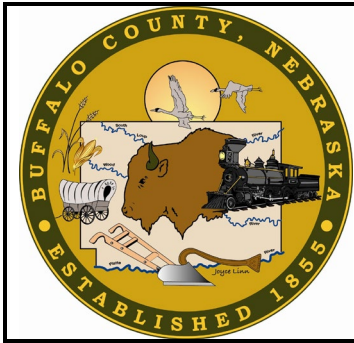

BUFFALO COUNTY ZONING & FLOODPLAIN
 Buffalo County Courthouse
 1512 Central Avenue
 PO Box 1270
 Kearney, NE 68848
 Phone: (308) 236-1998
 Fax: (308) 236-1870
 Email: zoning@buffalocounty.ne.gov

BUFFALO COUNTY ANNUAL ZONING REPORT

FROM: Dennise Daniels, Zoning Administrator

MEETING DATE: February 8, 2022

105 Zoning Applications were submitted in 2021, which generated \$13,695 in Zoning Fees and Permitted Values of \$17,175,100, to Buffalo County. Please note: the average price of a new home, based on the permits issued in 2021, was \$396,909.

Zoning Permits	Development-Type Permits	Other Considerations
33 Residences	13 Administrative Subdivisions	5 Permit Disapprovals
23 Outbuildings	3 Map Amendments	4 Voided Applications (Incomplete)
14 Garages/Additions	3 Special Use Permits	4 Re-Applications
5 Removal/Movement of Residences	1 Vacation of Plat	2 Permits Withdrawn
3 Mobile Homes/Campers		1 Permit Under Review
2 Sign Permits		2 Variances
1 Permit for 12 Storage Tanks with Containment, 3 Truck Pads		
1 "Use" Permit		
1 Removal & Construction of Convenience Store		

Each of Buffalo County's townships did well, overall. However, three townships provided the most permitted value:

	2021		2020		2019	
	Township	Value	Township	Value	Township	Value
1	Rusco	\$3,922,000	Riverdale	\$3,007,000	Riverdale	\$2,285,900
2	Riverdale	\$3,668,500	Rusco	\$2,372,000	Shelton	\$1,474,500
3	Center	\$2,361,000	Divide	\$1,697,000	Odessa	\$1,254,000

With the Comprehensive Plan fully underway, along with regular Buffalo County agenda items, The Planning and Zoning Commission met six times. The Board of Adjustment met twice.

Floodplain Fees, generated in 2021, was \$350.00, for ten floodplain permits. Two, however, were disapproved.

2021 Yearly Zoning Report

• Number of Permits: 105
• Average Value of House: \$396,909
• Township with Highest Value: Rusco (\$3,922,000)
• Highest Permit Issued: \$1,210,000

PERMIT #	APPL DATE	PERMIT TYPE	NAME	ADDRESS OF PROPERTY	LEGAL DESCRIPTION	VALUE	SIZE	DESCRIPTION	TOWNSHIP	NOTES
2021-050	6/21/2021	Zoning	Michael Saathoff	6509 Hwy 40	15,22-11-18 Pt SW 1/4	\$50,000	26'x48'	House movement, addition, & attached garage	Armada	
Armada Totals									\$50,000	
2021-013	3/5/2021	Zoning	Nick Schirmer	33467 340th Rd	20-12-15 Pt NE 1/4 SE 1/4	\$350,000	35'x65'	Residence	Beaver	DISAPPROVED 3/23/21; RESUBMITTED AS 2021-049
2021-023	3/19/2021	Zoning	Richard & Sylvia Zeller	33440 Poole Rd	23-12-15 Bob White Acres Lt 1	\$300,000	76'x40'	Residence	Beaver	
2021-049	6/21/2021	Zoning	Nick Schirmer	33467 340th Rd	20-12-15 Pt NE 1/4 SE 1/4	\$350,000	35'x65'	Residence	Beaver	
2021-055	6/29/2021	Administrative Sub	Bryce & Susan Riessland / Lawrence & Wanda Kessler		30-12-15 Pt G.L. 2			Administrative Sub	Beaver	
2021-057	7/9/2021	Zoning	Barbara Irvine	39239 370th Rd	12-12-15 Pt NE1/4 NE1/4	\$25,000	36'x48'	Detached Garage	Beaver	
2021-075	8/23/2021	Change of Zoning	Jeffrey Albers	34055 Hawk Rd	18-12-15 Pt SE 1/4 SW 1/4 G.L. 4			Change of Zoning	Beaver	VOIDED; REFUNDED; INCOMPLETE APPLICATION
2021-089	9/29/2021	Change of Zoning	Jeffrey Albers	34055 Hawk Rd	18-12-15 Pt G.L. 4			Rezoning	Beaver	
Beaver Totals									\$1,025,000	
2021-015	3/11/2021	Zoning	Shane Albers	28727 Cherry Rd	04-11-15 Pt N1/2 SW 1/4	\$600,000	116'x78'	Residence	Cedar	
Cedar Totals									\$600,000	
2021-005	1/22/2021	Administrative Sub	Robert & Brenda Bendfeldt		13-08-15 Pt N 1/2 NW 1/4			Administrative Sub	Center	
2021-038	5/17/2021	Zoning	Luke & Kara Choyeski	10710 Madison Pl	06-09-15 Madison Way Estates Lt 2 Blk 2	\$350,000	90'x34'	Residence	Center	
2021-067	8/9/2021	Zoning	Ft Kearney Trading Post, Mark & Peggy Garrels	1730 Hwy #10	01-08-15 Rouse Fourth Adm Sub Lt 1	\$1,210,000	70'x62'	Single Level Wood Framed Structure	Center	
2021-082	9/13/2021	Zoning	Jason Potter	3210 E 97th St	08-09-15 Antelope Park Estates Lts 3-5 Blk 2	\$800,000	100'x70'	Residence	Center	
2021-087	9/24/2021	Zoning	Scott Javins	2490 E 106th St Circle	06-09-15 Madison Way Estates	\$1,000	12'x12'	Attached Shed	Center	
Center Totals									\$2,361,000	
2021-019	3/11/2021	Zoning	Sharon Eckelberger	3850 Dove Hill Ave	31-09-16 Pt G.L. 3	\$132,000	90'x44'	Storage Building	Collins	
2021-033	5/5/2021	Zoning	Paul & Amy Hazard	8200 W 56th St	30-09-16 Pt G.L.s 3,4 & 9	\$685,000	100'x60'	Residence	Collins	
2021-074	8/23/2021	Special Use Permit	Spirit of Life Church	2530 Dove Hill Ave	31-09-16 Pt Lt 22	\$4,100		Church Sign	Collins	VOIDED; REFUNDED; INCOMPLETE APPLICATION
2021-090	10/13/2021	Zoning	Scout Enterprises	2720 72nd Avenue	Pollat Acres Sub, Lot 4 (31-9-16)	\$150,000	50'x72'	Utility Shed	Collins	UNDER REVIEW; LITIGATION PENDING
Collins Totals									\$971,100	
2021-042	6/2/2021	Zoning	Tyler & Jamie Fead	12955 Stagecoach Lane	35-10-16 Iron Horse Sub Lt 1 Blk 1	\$497,000	77'x36'	Residence	Divide	
2021-062	7/14/2021	Zoning	Eric Hollingsworth	16610 YDC Rd	16-10-16 Pt SE 1/4	\$34,000	30'x60'	Pole Barn	Divide	
2021-063	7/15/2021	Zoning	Shirley & Harold May	16670 Green Hill Rd	17-10-16 NW1/4, Pt NE1/4, NE1/4 SW1/4 & N1/2 SE 1/4	\$7,800	16'x20'	Garage	Divide	
Divide Totals									\$538,800	
2021-002	2/12/2021	Administrative Sub	Steven & Judi Martin & Joshua & Colleen Martin		08-09-18 Pt SE 1/4 SE 1/4			Administrative Sub	Elm Creek	
Elm Creek Totals									\$0	
2021-021	3/24/2021	Vacation of Plat	Roger & Renee Swearingen		36-09-14 Lingers Sub Pt Lt 9			Vacation of Plat	Gibbon	
2021-022	3/15/2021	Administrative Sub	Roger & Renee Swearingen		36-09-14 Pt NE 1/4 SW 1/4			Administrative Sub	Gibbon	
2021-036	5/5/2021	Zoning	Dru Chramosta	3940 Pawnee Road	25-9-14 S370' E423' SE1/4	\$60,000	50' x 30'	Garage	Gibbon	
2021-047	6/7/2021	Zoning	Mauslein Land Holdings	39938 Highway 30	30-09-14 Pt N1/2 NW 1/4	\$2,800	NA	Sign	Gibbon	
2021-093	10/19/2021	Change of Zoning	Simplot AB Retail Sub, Inc		30-9-14 Pt G.L. 1 tax parcel 660286130			Rezoning	Gibbon	
2021-105	12/17/2021	Zoning	Simplot AB Retail Sub, Inc	39695 E 56th Road	30-9-14 Tr in N1/2 NW1/4 N of RR	\$400,000		3 Cement Truck Loading Pads, Fertilizer tanks (12), & Containment	Gibbon	
Gibbon Totals									\$462,800	

2021 Yearly Zoning Report

PERMIT #	APPL DATE	PERMIT TYPE	NAME	ADDRESS OF PROPERTY	LEGAL DESCRIPTION	VALUE	SIZE	DESCRIPTION	TOWNSHIP	NOTES
2021-070	8/20/2021	Zoning	Land Owner Clark Nuttelman	14720 Amherst Rd	20-10-17 Pt SE 1/4	\$150,000	40'x70'	Moving Residence	Grant	
Grant Totals									\$150,000	
2021-079	9/3/2021	Administrative Sub	Heartland Trust Co, Personal Rep of Charlotte & Harold Burkeys Estate		20-10-18 Pt S 1/2 SW 1/4			Administrative Sub	Logan	
Logan Totals									\$0	
2021-084	9/20/2021	Zoning	Ben Unick	37585 Dove Hill Rd	06-12-16 E716' W 1525' N 802' Lt 16	\$400,000	36'x107'	Removal of residence & construction of new	Loup	
Loup Totals									\$400,000	
2021-014	3/5/2021	Zoning	Brent & Nicole Downey	6335 Yellow Rose Lane	24-9-17 Bridle Acres 4th Lt 3 Blk 2	\$70,000	40'x60'	Detached Garage/Shop	Odessa	
2021-017	3/11/2021	Change of Zoning	Galen & Debra Killion	5292 Eagle Rd	27-09-17 Pt NE 1/4 NE 1/4			Chg of Zoning	Odessa	WITHDRAWN 3/23/21; REFUNDED
2021-018	3/11/2021	Administrative Sub	Galen & Debra Killion		27-09-17 Pt NE 1/4 NE 1/4			Administrative Sub	Odessa	
2021-037	5/14/2021	Zoning	Brandon Rohr	8210 Evergreen Rd	13-09-17 Pt N1/2 NE 1/4	\$400,000	64'x62'	Residence	Odessa	
2021-039	5/18/2021	Administrative Sub	Michael & Gladys Carmody		34-09-17 Pt NW1/4 SW 1/4			Administrative Sub	Odessa	
2021-048	6/16/2021	Zoning	R & J, W Development	7950 Evergreen Rd	13-09-17 Pt SW 1/4 NW 1/4 & SW 1/4 NE 1/4	\$120,000	50'x120'	Metal Building	Odessa	
2021-052	6/28/2021	Zoning	Travis Anderson	8406 Evergreen Rd	13-09-17 Pt N1/2 NE1/4	\$200,000	90'x31'	Residence	Odessa	
2021-066	8/9/2021	Zoning	Kevin & Maggie Mansfield	2520 Amherst Rd	32-09-17 Pt SE 1/4 SE 1/4	\$207,000	30'x76'	Removal & Replacement of Mobile Home	Odessa	
2021-072	8/19/2021	Zoning	Jason & Amy Martinez	6050 Standage Place	24-9-17 Standage Country Est 2nd Lt 6	\$130,000	50'x100'	Out Building	Odessa	
2021-085	9/21/2021	Zoning	Tyler Smith	340 Webb St	33-09-17 Odessa Village, Lots 129-132 & W7' Webb St	\$250,000	28'x68'	Removal of existng home & installation of new modular	Odessa	
2021-097	10/26/2021	Special Use Permit	Adam Marshall, McMarshall Investments LLC	17675 Hwy 30	03-08-17 that part Lots 2, 3, & 4 lying north of RR Row			Signage	Odessa	
2021-098	10/26/2021	Special Use Permit	Adam Marshall, McMarshall Investments LLC	17675 Hwy 30	03-08-17 that part Lots 2, 3, & 4 lying north of RR Row			Signage	Odessa	
2021-100	11/1/2021	Zoning	Mark Schnacker	4686 Odessa Rd	28-09-17 Sullwold Acres Lt 1	\$12,000	20'x16'	Garden/Chicken Shed	Odessa	
2021-102	11/23/2021	Zoning	Kerry Sparks	8214 Evergreen Rd	13-09-17 Pt N 1/2 NE 1/4 & NE 1/4 NW 1/4	\$425,000	102'x65'	Residence/ Garage	Odessa	
Odessa Totals									\$1,814,000	
2021-020	2/12/2021	Zoning	Del & Sue Lienemann	45857 Coal Chute Rd	02-08-14 Pt G.L. 4	\$25,000	30'x24'	Barn	Platte	
2021-034	5/5/2021	Zoning	Miles Maddux	1424 Lowell Road	12-8-14 Tract in Gov Lot 3	\$100,000	46' x 34'	Additions/Deck Replacement/Solar Panels	Platte	DISAPPROVED 5/17/21; LITIGATION PENDING
2021-041	5/27/2021	Variance	Thomas Miles Maddux	1424 Lowell Road	12-08-14 Pt G.L. 3 NW 1/4			Variance	Platte	DISAPPROVED 7/8/2021
2021-058	7/9/2021	Zoning	Kevin Kreger	47625 Kilgore Rd	01-08-14 Saalfed Acres Lot 1	\$40,000	24'x26'	Garage Addition	Platte	
2021-076	8/27/2021	Zoning	Miles Maddux	1424 Lowell Road	12-08-14 Tr in Lt 3	\$315,000	44'x32'	Addition	Platte	DISAPPROVED 10/19/21; LITIGATION PENDING
Platte Totals									\$480,000	
2021-009	2/19/2021	Zoning	Brandon Ross	6920 82nd St	18-09-16 85th St Deer Country Est 2nd Lt 1, Blk 3	\$410,000	67'x47'	Residence	Riverdale	
2021-029	4/1/2021	Zoning	Joe Maul	25250 115th Rd	04-09-16 Pt NE1/4	\$15,000	24'x30'	Steel Building	Riverdale	
2021-031	4/16/2021	Zoning	Christine Wilson	8215 Hidden Hills Rd	18-09-16 Pt of G.L. 4			Use Permit	Riverdale	
2021-032	4/29/2021	Zoning	Grant & Sandie Monie	8055 69th Ave Place	18-09-16 85th Deer Country Est 2nd Lt 3 Blk 3	\$450,000	46'x91'	Residence	Riverdale	
2021-035	5/6/2021	Zoning	Nate Bruner	7845 W 70th St	18-09-16 Pt G.L. 16	\$100,000	40'x60'	Accessory Structure	Riverdale	
2021-040	5/24/2021	Zoning	Scott & Annette Stansbury	1315 W 112th Rd	02-09-16 E391.2' of W1727.87' of S334.08' of N960.19' NW 1/4	\$100,000	42'x64'	Post Frame Building	Riverdale	
2021-056	7/7/2021	Zoning	Brett Haffener	10755 17th Ave	02-09-16 Miracle Hills Estates Lt 1 Blk 2	\$90,000	35'x24'	Addition	Riverdale	

2021 Yearly Zoning Report

PERMIT #	APPL DATE	PERMIT TYPE	NAME	ADDRESS OF PROPERTY	LEGAL DESCRIPTION	VALUE	SIZE	DESCRIPTION	TOWNSHIP	NOTES
2021-060	7/13/2021	Zoning	Midwest Elite Contracting- Dave Mackey	6250 W 88th St	07-19-16 Woodward Estates Third Lt 1 Blk 2	\$500,000	78'x43'	Residence	Riverdale	
2021-061	7/14/2021	Zoning	Casey Schilke	6871 W 88th St	07-09-16 CEA 2nd Sub Lt 1 Blk 1	\$8,000	25'x62'	Storage Building	Riverdale	
2021-065	7/30/2021	Zoning	Mike Sughroue	8136 Cottonmill Ave	18-09-16 Pt E 1/2 NE 1/4	\$46,000	40'x60'	Pole Barn	Riverdale	
2021-069	8/13/2021	Zoning	Trent Delehant	8465 68th Ave	18-09-16 85th St Deer Country Estates Lt 1 Blk1	\$268,000	62'x62'	Residence	Riverdale	
2021-071	8/18/2021	Zoning	Donald Parsons	8460 69th Ave	18-09-16 85th St Deer Country Estates Lt 1 Blk 2	\$410,000	98'x38'	Residence	Riverdale	
2021-077	8/31/2021	Zoning	Tyler McNitt	10075 30th Ave	03-09-16 Pt SW 1/4	\$65,000	30'x40'	Accessory Storage Structure & conversion of existing storage structure to residence	Riverdale	
2021-088	9/29/2021	Zoning	Sue Grupe	8280 Hidden Hills Estates	18-09-16 Hidden Hills Estates Lt 3	\$135,000	14'x40'	Residence, Temporary residence in camper, shed	Riverdale	
2021-094	10/21/2021	Zoning	Matt Bowman	6255 W 88th St	07-09-16 Woodward Estates Third Blk 1 Lt 5	\$1,500	18'x21'	Car Port	Riverdale	
2021-095	10/21/2021	Zoning	Austin Buerer	28105 115th Rd	02-09-16 Pt NE 1/4 NW 1/4	\$150,000	40'x80'	Pole Barn	Riverdale	VOIDED; REFUNDED; INCOMPLETE APPLICATION 11/2/21; RESUBMITTED AS 2021-101
2021-099	11/1/2021	Zoning	Steve & Daralane Griffiths	8240 Cottonmill Ave	18-09-16 Pt NE 1/4 NE 1/4 & Pt E 1/2 NE 1/4	\$700,000	68'x45'	Residence	Riverdale	
2021-101	11/8/2021	Zoning	Smash Factor, LLC. Attn: Austin Buerer	28105 115th Rd	02-09-16 Pt NE 1/4 NW 1/4	\$150,000	40'x80'	Pole Barn	Riverdale	
2021-104	12/29/2021	Zoning	Aaron Foster	1120 W 105th St PI	02-09-16 Miracle Hills Estates Lt 23 Blk 3	\$70,000	48'x36'	Storage Building	Riverdale	
Riverdale Totals									\$3,668,500	
2021-010	2/22/2021	Zoning	Jesse Riens	21185 Clubhouse Drive	36-11-16 Praire Acres 2nd Lt 3 Blk 2	\$300,000	71'x36'	Residence	Rusco	
2021-024	3/19/2021	Zoning	B & G Investments Inc LLC	11 Golfside Drive	36-11-16 Golfside Estates Lt 5	\$275,000	66'x63'	Residence	Rusco	
2021-025	3/19/2021	Zoning	B & G Investments LLC		36-11-16 Golfside Estates Lt 6	\$275,000	50'x70'	Residence	Rusco	WITHDRAWN 3/21; REFUNDED
2021-026	3/19/2021	Zoning	B & G Investments LLC	19 Golfside Drive	36-11-16 Golfside Estates Lt 7	\$275,000	50'x70'	Residence	Rusco	
2021-044	6/7/2021	Zoning	Nathan & Jeanne Lightle	9 A Avenue Place	36-11-16 The Greens at Prairie Hills 1st Blk 2 Lt 5	\$450,000	73'x54'	Residence	Rusco	
2021-051	6/25/2021	Zoning	Scott Phillips	2 Praire Hills Rd	36-11-16 The Greens at Prairie Hills 1st, Lt 10 Blk 2	\$5,000	8'x10'	Sign	Rusco	
2021-059	7/13/2021	Zoning	Ryan Lindner	20685 Clubhouse Dr	36-11-16 Pt E1/2 W 1/2	\$35,000	36'x50'	Pole Barn	Rusco	
2021-064	7/28/2021	Zoning	Ryan and Megan Smith	21050 Clubhouse Dr	36-11-16 Praire Acres 2nd Lt 3 Blk 1	\$525,000	2300 sq ft	Residence	Rusco	
2021-073	8/20/2021	Zoning	Curt & Lorri Mayo	31 Sawgrass Dr	36-11-16 Golfside #4 Subdivision: Outlot A & Lot 3	\$250,000	30'x84'	Residence	Rusco	
2021-083	9/13/2021	Zoning	Nicholas Cruise	13 A Avenue Place	36-11-16 The Greens at Praire Hills Blk 2 Lt 6	\$500,000	84'x48'	Residence	Rusco	
2021-091	10/15/2021	Zoning	Scott and Lisa Phillips	8 Ave A Place	36-11-16 NW 1/4 The Greens Prairie Hills 1st Blk 2 Lt 8	\$485,000	70'x90'/36'x52'	Residence & Garage	Rusco	VOIDED; REFUNDED; RESUBMITTED AS PERMIT #2021-092
2021-092	10/19/2021	Zoning	Highway 10 Development LLC	8 Ave A Place	36-11-16 NW 1/4 The Greens Prairie Hills 1st Blk 2 Lt 8	\$485,000	70'x90'/36'x52'	Residence	Rusco	
2021-103	11/30/2021	Zoning	Kyle Cruise	21400 Clubhouse	36-11-36 Pt W 1/2	\$40,000	40'x30'	Attached Garage	Rusco	
2021-068	8/11/2021	Zoning	Michael Ellis	23975 Dove Hill Rd	19-11-16 Pt G.L.s 2,3,10 & 11	\$22,000	40'x27'	Removal & Replacement of Mobile Home	Rusco	DISAPPROVED 8/26/21
2021-080	9/3/2021	Variance	Michael Ellis	23975 Dove Hill Rd	19-11-16 Pt G.L.s 2,3,10 & 11			Variance	Rusco	DISAPPROVED 10/28/21
Rusco Totals									\$3,922,000	
2021-030	5/17/2021	Zoning	Keith Smith	11235 370th Rd	07-12-17 Pt SE 1/4 NW 1/4 of G.L. 2	\$80,000	77'x50'	Residence/Shop	Sartoria	
Sartoria Totals									\$80,000	
2021-011	2/26/2021	Zoning	Keith Keaschall	25045 Navaho Rd	14-11-14 Pt S 1/2 SW 1/4	\$350,000	46.5'x90'	Residence	Schneider	
2021-012	2/26/2021	Administrative Sub	Kelly & Nichole Bock		7-11-14 Pt NE 1/4 NE 1/4			Administrative Sub	Schneider	
Schneider Totals									\$350,000	
2021-016	3/11/2021	Zoning	Justin Taubenheim	22786 Eagle Rd	27-11-17 Taubenheim Acres Lt 1	\$408,000	37'x56'	Residence	Scott	
Scott Totals									\$408,000	
2021-003	1/19/2021	Administrative Sub	Riley Mayfield, etal		27-10-13 Pt SW 1/4 SW 1/4			Administrative Sub	Sharon	
Sharon Totals									\$0	

2021 Yearly Zoning Report

PERMIT #	APPL DATE	PERMIT TYPE	NAME	ADDRESS OF PROPERTY	LEGAL DESCRIPTION	VALUE	SIZE	DESCRIPTION	TOWNSHIP	NOTES
2021-001	1/14/2021	Zoning	Marsh Contraction (Jeff Marsh)	12 Lakeside Drive	24-09-13 Bruner Lakeside Est 2nd Lt 7 Blk 1	\$400,000	2250 ft	Residence & Outbuilding	Shelton	
2021-004	1/22/2021	Administrative Sub	Ronald Follmer		23-09-13 Pt NE 1/4 NE 1/4			Administrative Sub	Shelton	
2021-006	1/27/2021	Zoning	Michael & Sherry Smith	37 Catfish Cove Place	24-9-13 Bruner Lakeside Est Lt 1	\$60,000	45'x42'	Shop Building	Shelton	
2021-008	2/24/2021	Zoning	Doug & Cheryl Woodman	2 Lakeside Dr	24-09-13 Bruner Lakeside Est 2nd Lt 12 Blk 1	\$310,000	42'x93'	Residence	Shelton	ASSESSOR VALUE
2021-028	4/5/2021	Zoning	Phil Baldwin	55705 70th Rd	23-9-13 Baldwin Acres Lt 1	\$250,000	NA	Residence & Pole Barn	Shelton	
2021-043	6/7/2021	Zoning	Dave & Connie Rocker	30 Eagle Roost Pl	24-09-13 Pt G.L. 2	\$600,000	108'x57'	Residence	Shelton	
2021-046	6/7/2021	Zoning	Jim Bruner & Gayle Knoll	6995 Shelton Rd	24-09-13 Pt NW1/4 NW1/4 & Pt G.L. 2	\$30,000	18'x20'	Covered Patio	Shelton	
2021-078	9/1/2021	Special Use Permit	UDDUP LLC, Alissa Kern	51460 100th Rd	05-09-13 Pt SE 1/4			Special Use Permit	Shelton	
2021-081	9/3/2021	Zoning	Inez Schneider	3905 Range Rd	29-09-13 Lot 6 & 32-09-13 Pt NW 1/4 NE 1/4 & NE 1/4 NW 1/4	\$100,000	24'x52'	Cabin	Shelton	DISAPPROVED 10/1/21
Shelton Totals									\$1,750,000	
2021-007	1/28/2021	Zoning	Thomas Noller	33890 130th Rd	28-10-15 Pt E 1/2 SW 1/4	\$30,000	28'x30'	Garage	Thornton	
2021-054	6/29/2021	Administrative Sub	Carol Wiese		24-10-15 Pt SW 1/4 SW 1/4			Administrative Sub	Thornton	
2021-096	10/26/2021	Zoning	Albert & Janice Loeffelholz		06-10-15 Pt SW 1/4 SE 1/4			Administrative Sub	Thornton	
2021-086	9/24/2021	Change of Zoning	Albert & Janice Loeffelholz	31240 190th Rd	06-10-15 Pt SW 1/4 SE/4			Change of Zoning	Thornton	
Thornton Totals									\$30,000	
2021-027	3/23/2021	Zoning	Shane Thyne	145 Snowy Ridge Rd	21-10-14 Blue Sky Estates Blk 1 Lts 26 & 27	\$45,000	50'x56'x18'	Pole Barn	Valley	
2021-045	6/7/2021	Zoning	Travis Hollman	265 Star Lane	21-10-14 Blue Sky Estates Lt 5 Blk 1	\$20,000	12'x18'	Addition	Valley	
2021-053	6/29/2021	Administrative Sub	James & Wilma Skala, Trustees		26-10-14 Pt NE 1/4 NE 1/4			Administrative Sub	Valley	
Valley Totals									\$65,000	
		Address Only	Ron Follmer	42350 Kilgore Road	8-8-14 Pt Lots 7 & 8 & Pt Lots 3 & 9 9-8-14					
2021 County Value of Permit Preliminary Totals									\$19,126,200	
Withdraws/Denials/Under Review									\$1,951,100	
2021 County Value of Final Permit Totals (Less Withdraws/Denials/Reviews)									\$17,175,100	
2020 County Value of Permits Total									\$12,160,031	+41% Value 2020/2021
2019 County Value of Permits Total									\$8,199,300	